



# SeceuroGlide Compact Garage Door Fitting Instructions



**SeceuroGlide** | Sectional Compact  
Rear Mounted System

# Fitter's Information Pack - SeceuroGlide Sectional Compact

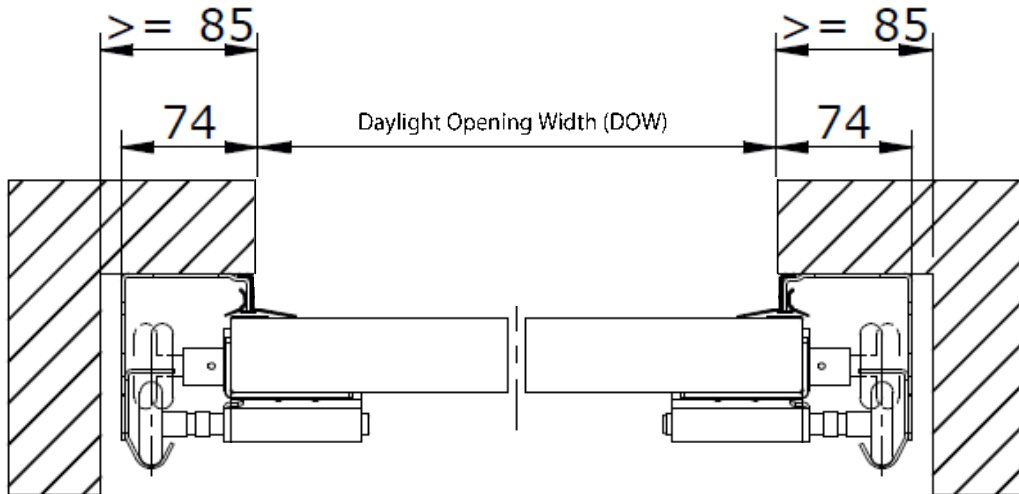
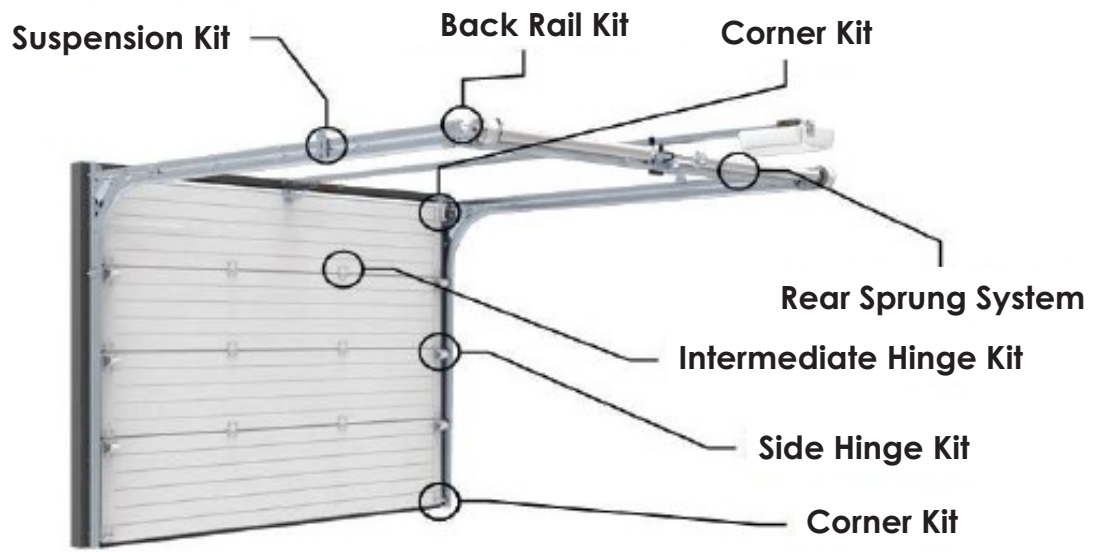

- ✓ EN 12604
- ✓ EN 12453
- ✓ EN 13241

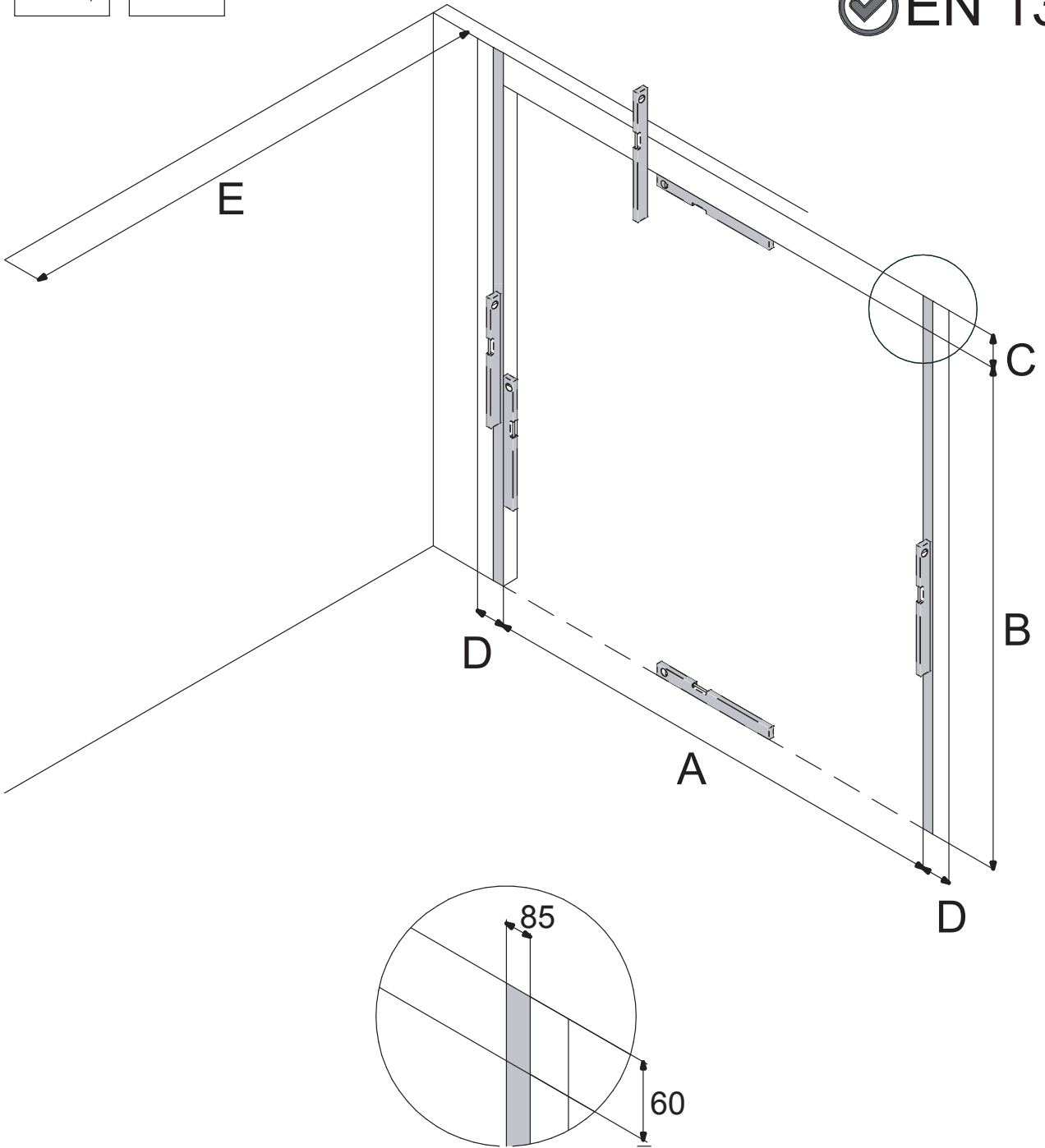
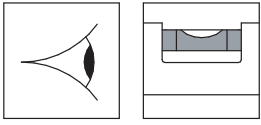

A	B	C	D	E
<b>DLW</b>	<b>DLH</b>	<b>FHR</b>	<b>FSR</b>	<b>FMD</b>
Daylight Width	Daylight Height	Free Head Room	Free Side Room	Free Mounting Dept

Seals are 100mm larger than needed,  
cut down to suit the opening

Slide weather seals onto  
vertical tracks

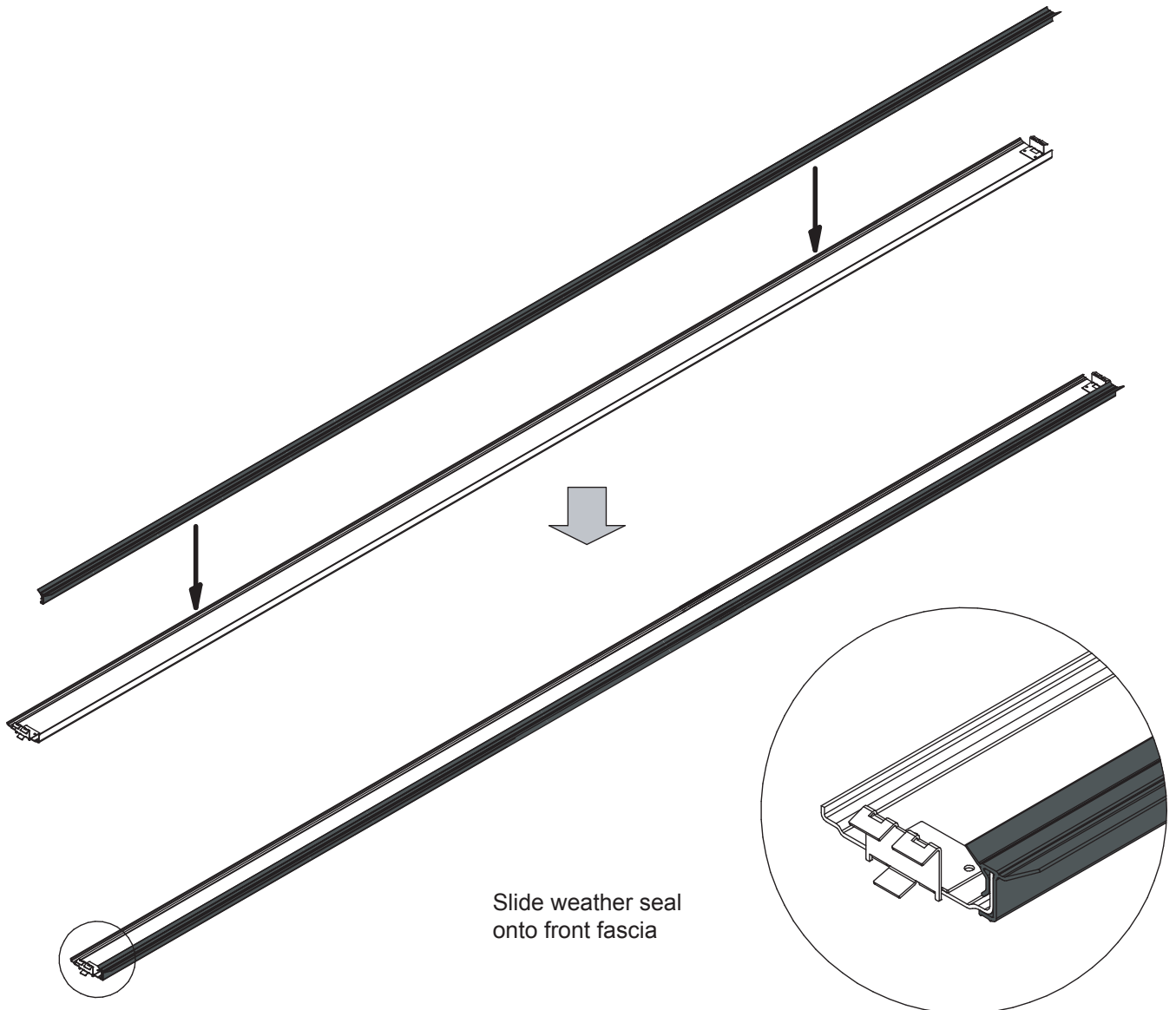
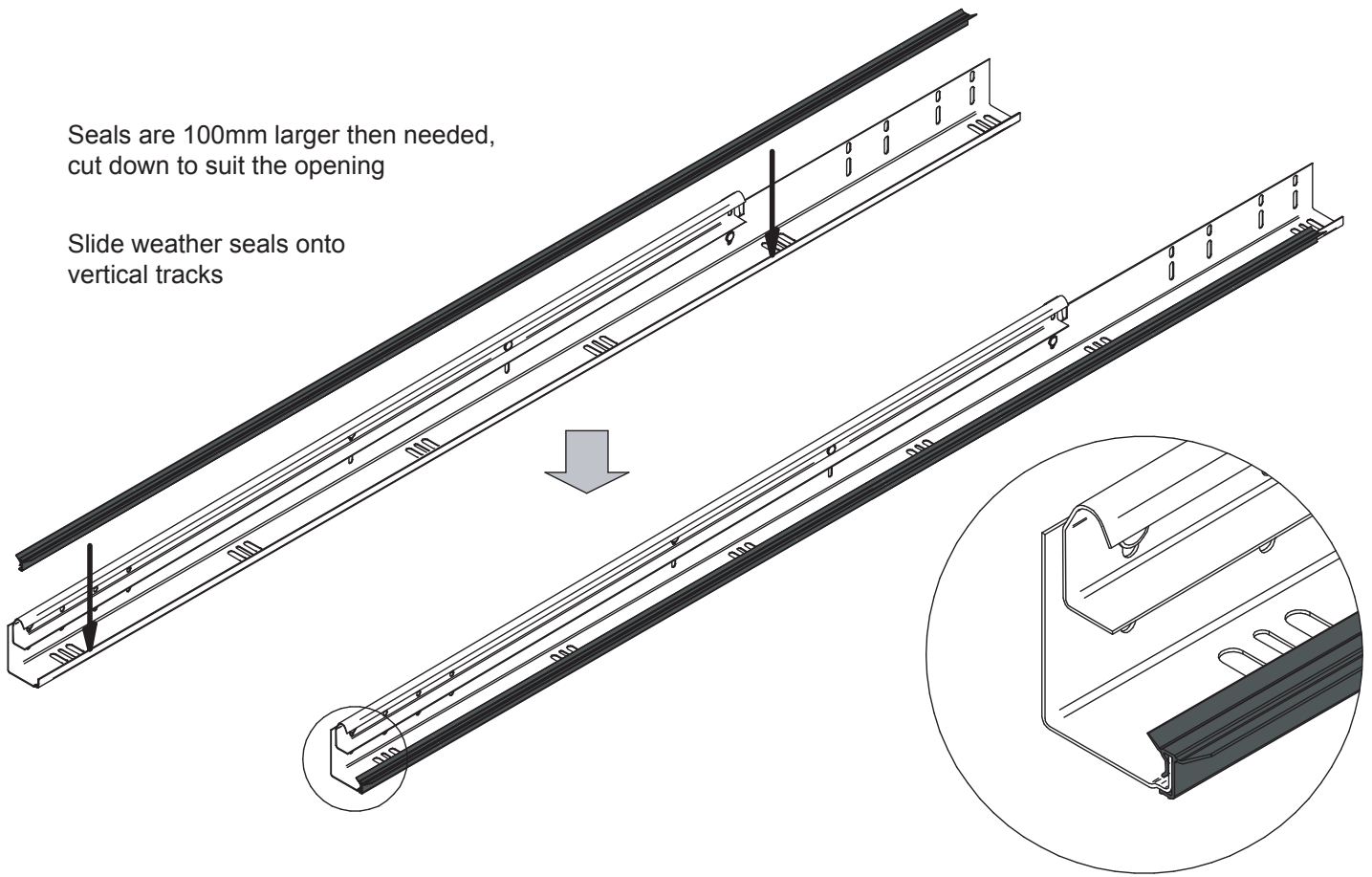

Slide weather seal  
onto front fascia

Clamp tracks to the wall

Lift fascia into place and secure

Insert the back bar between angles to determine the track width

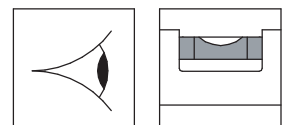
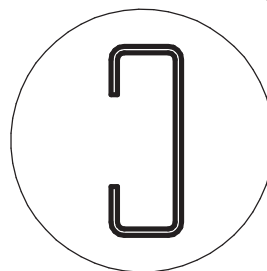
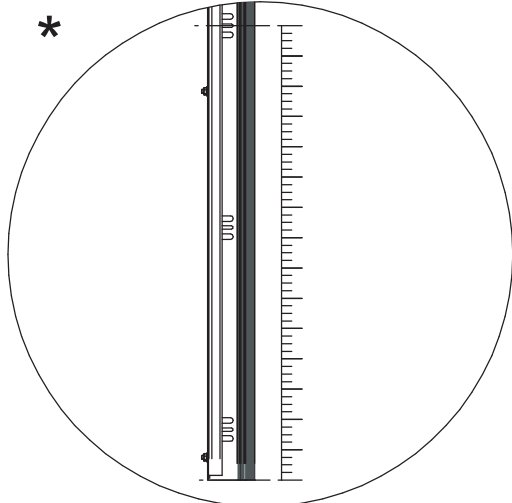

Secure the tracks to the wall with the appropriate fixings shown below

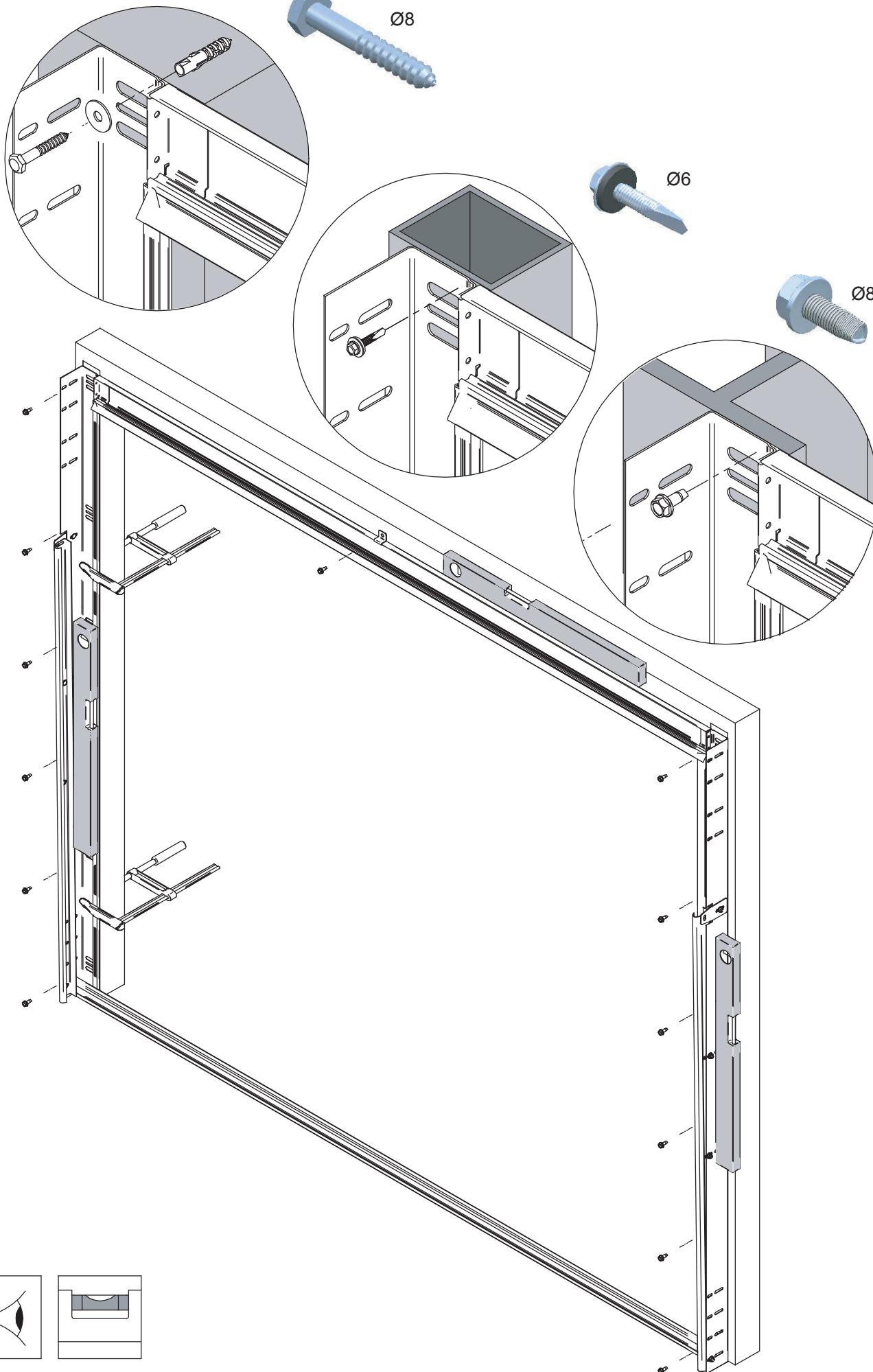

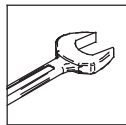
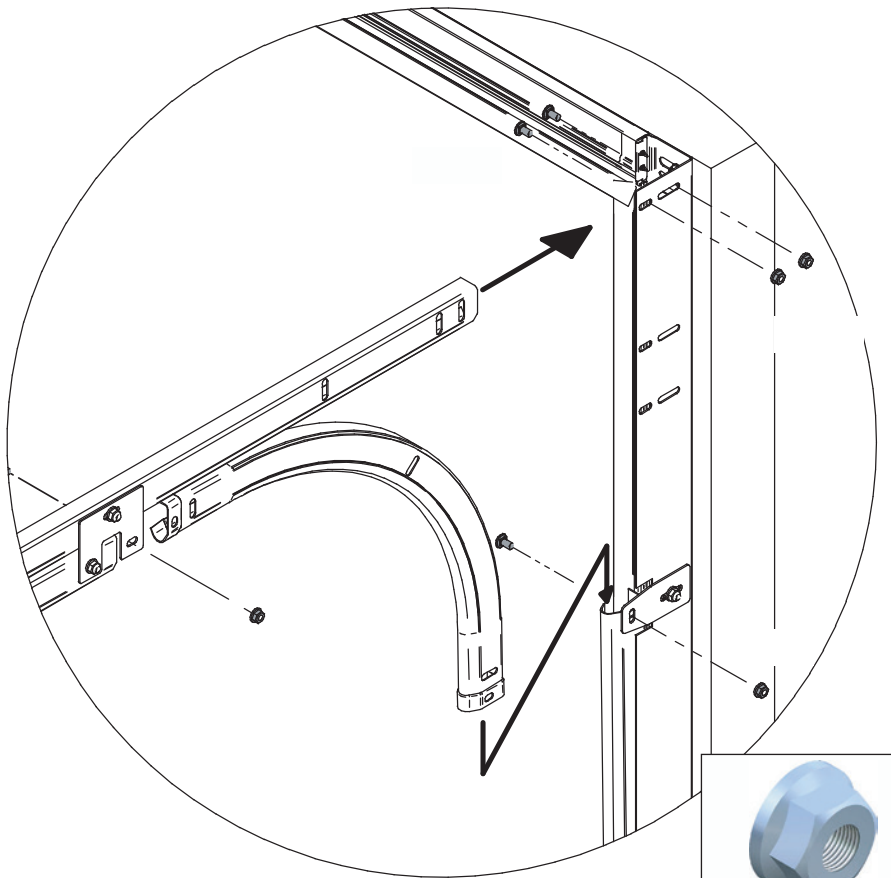
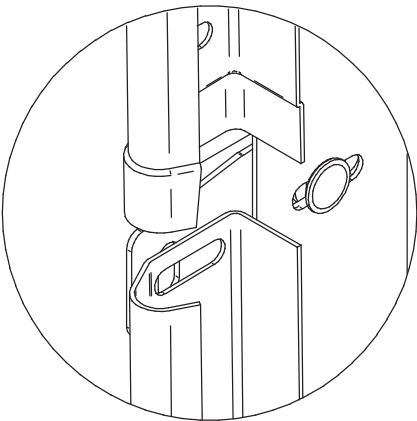
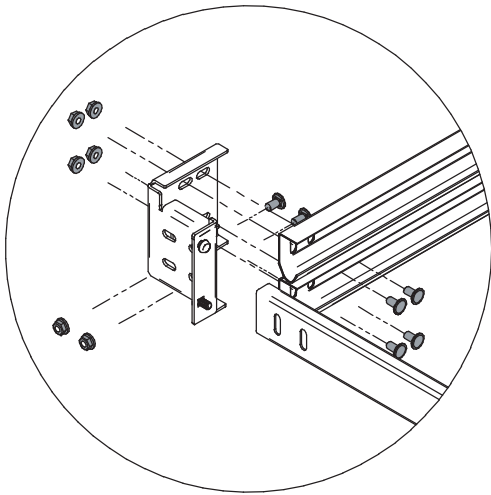
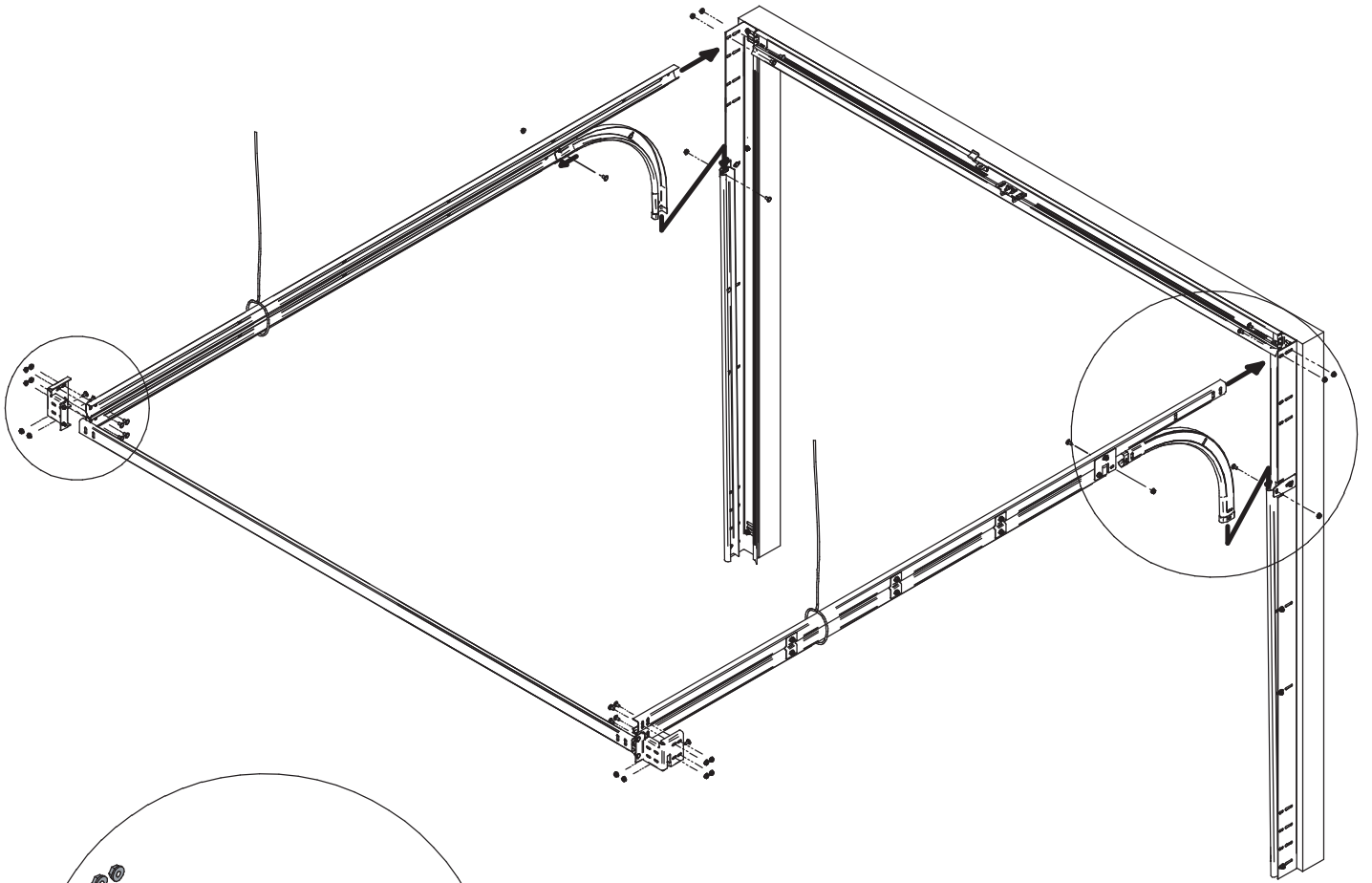

Bolt both horizontal tracks to the vertical tracks securely. Fix the rear bar to secure the horizontal tracks at the rear

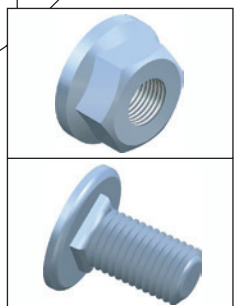

Secure front pulley plates to frame

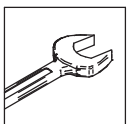
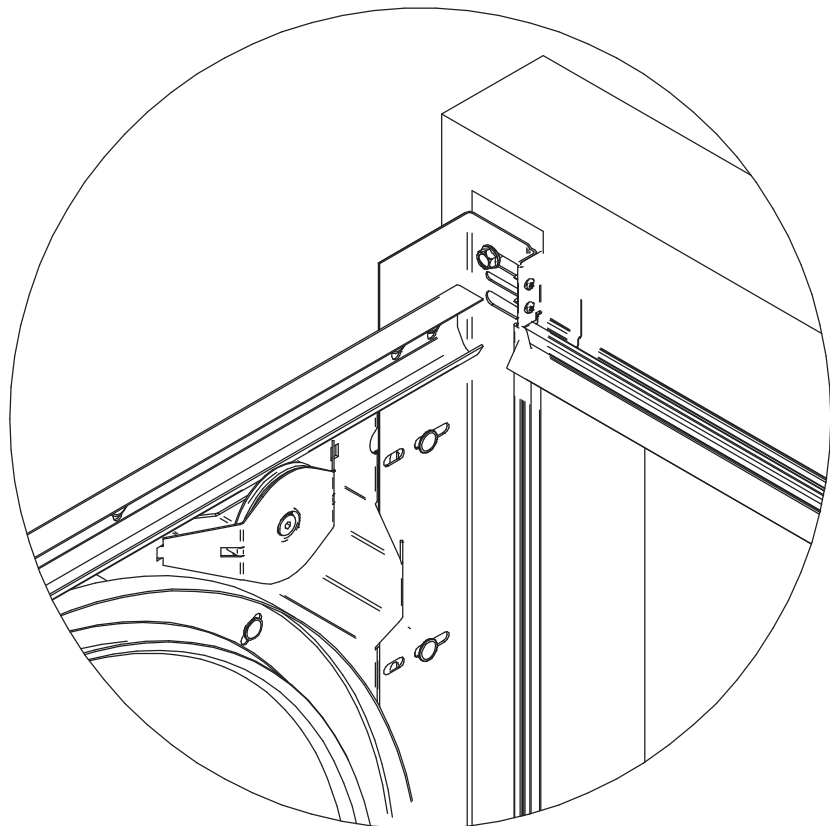
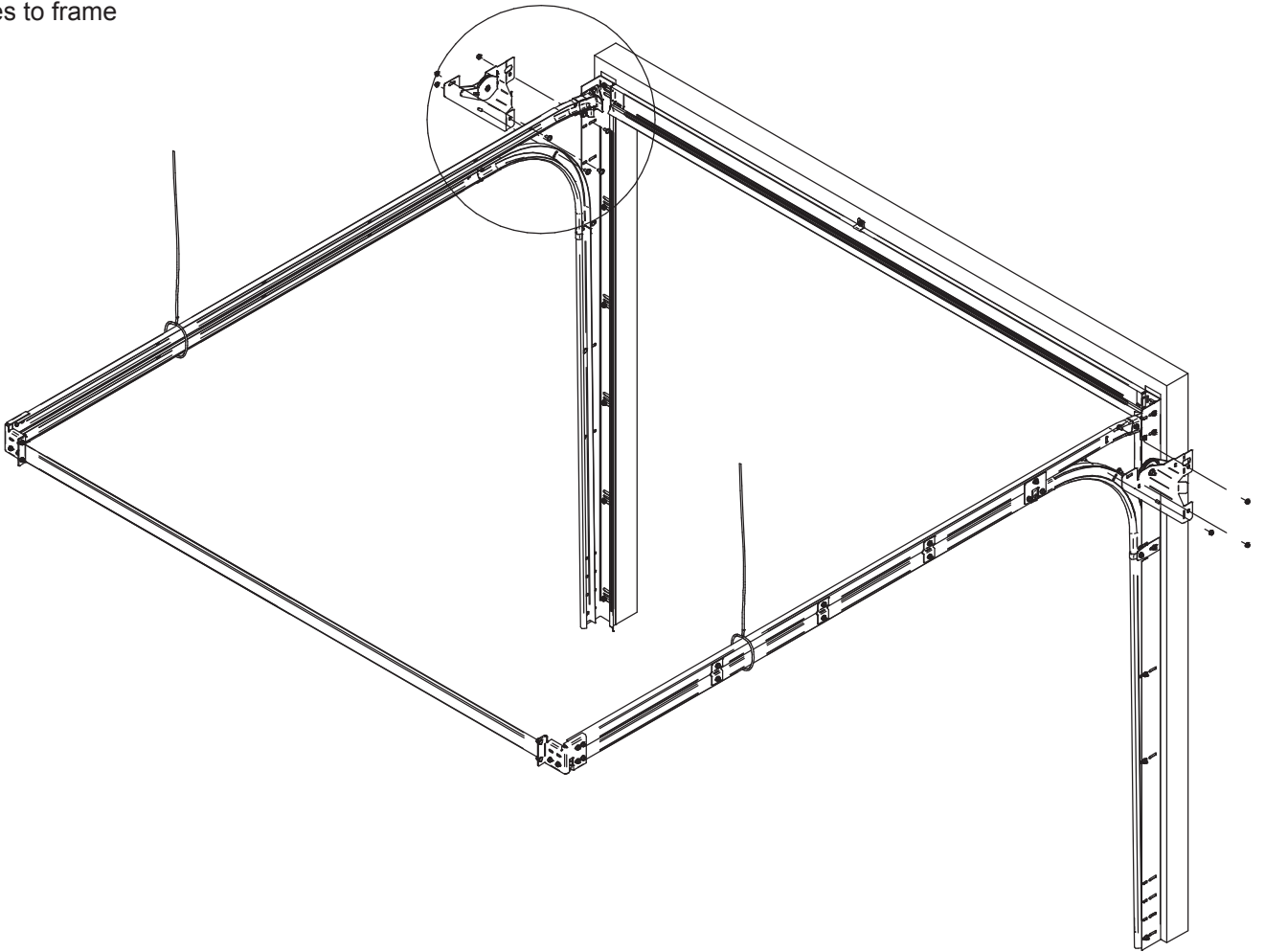



Measure from corner to corner to determine if the horizontal track area is square, adjust accordingly. Before securing the L shape hangers, ensure the horizontal tracks are level

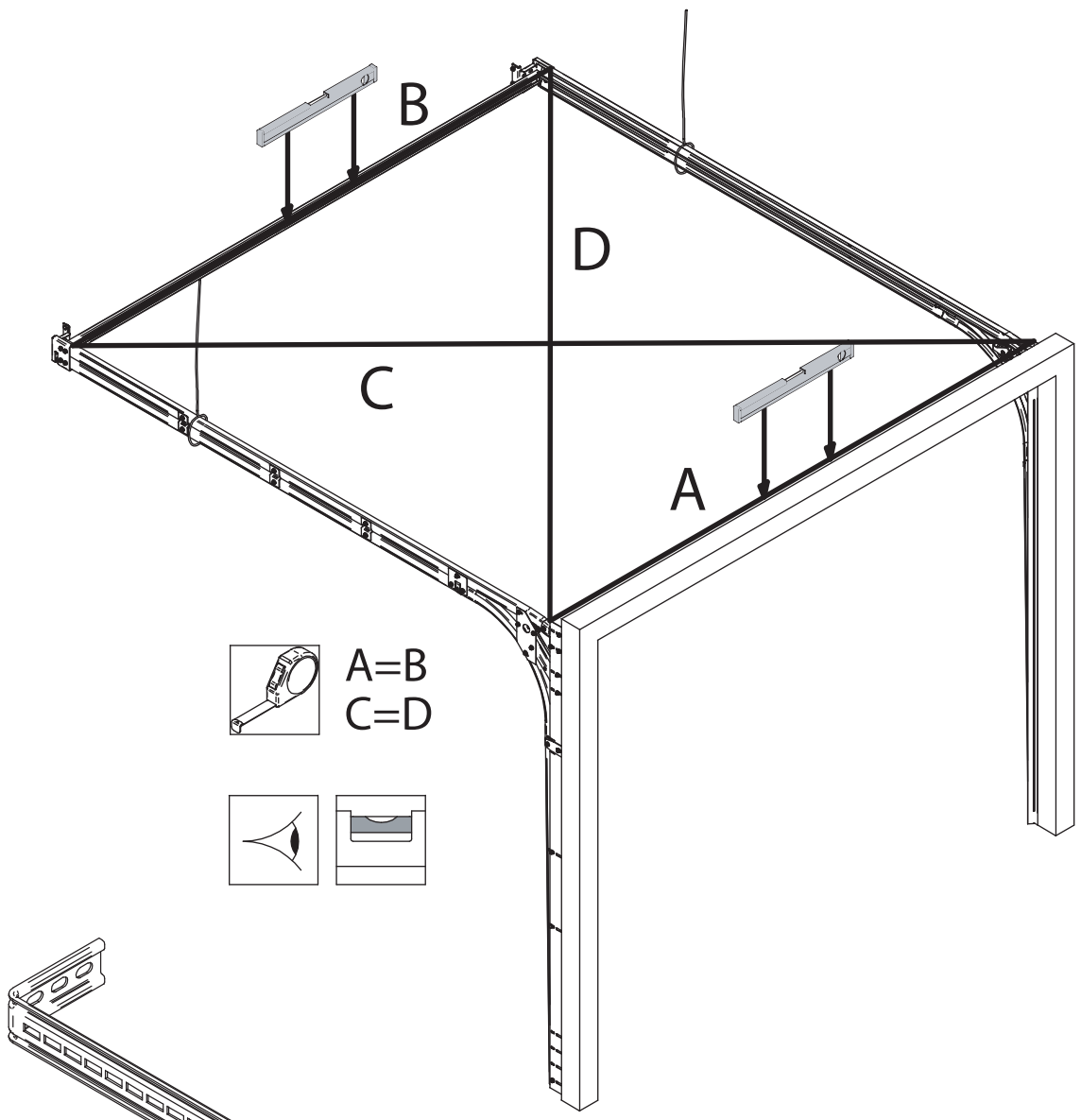

Using the L shape hangers and the clamping brackets secure the back bar to neighbouring walls

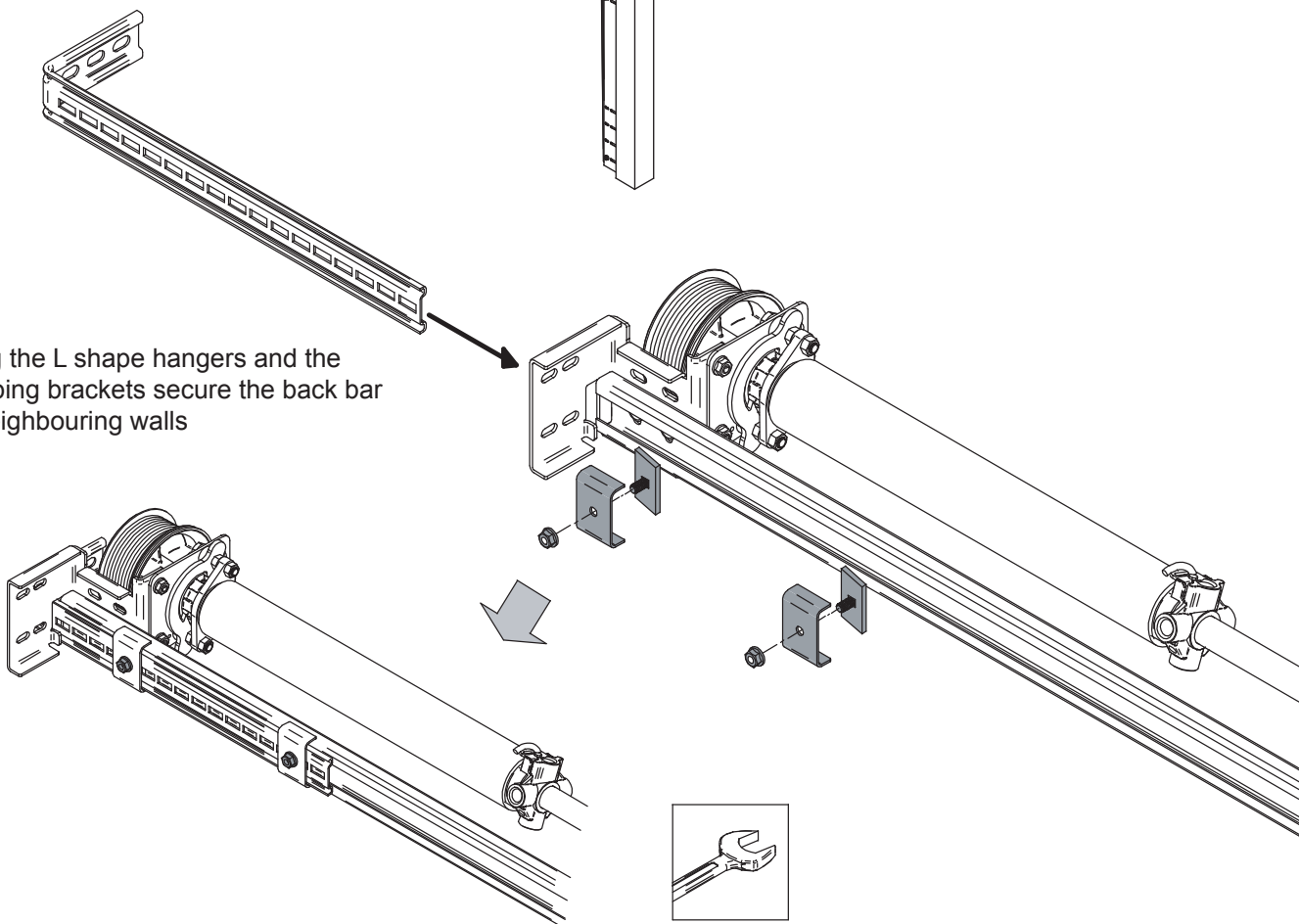

Fit L shape hanger to horizontal track and position to underside of adequate fixing point

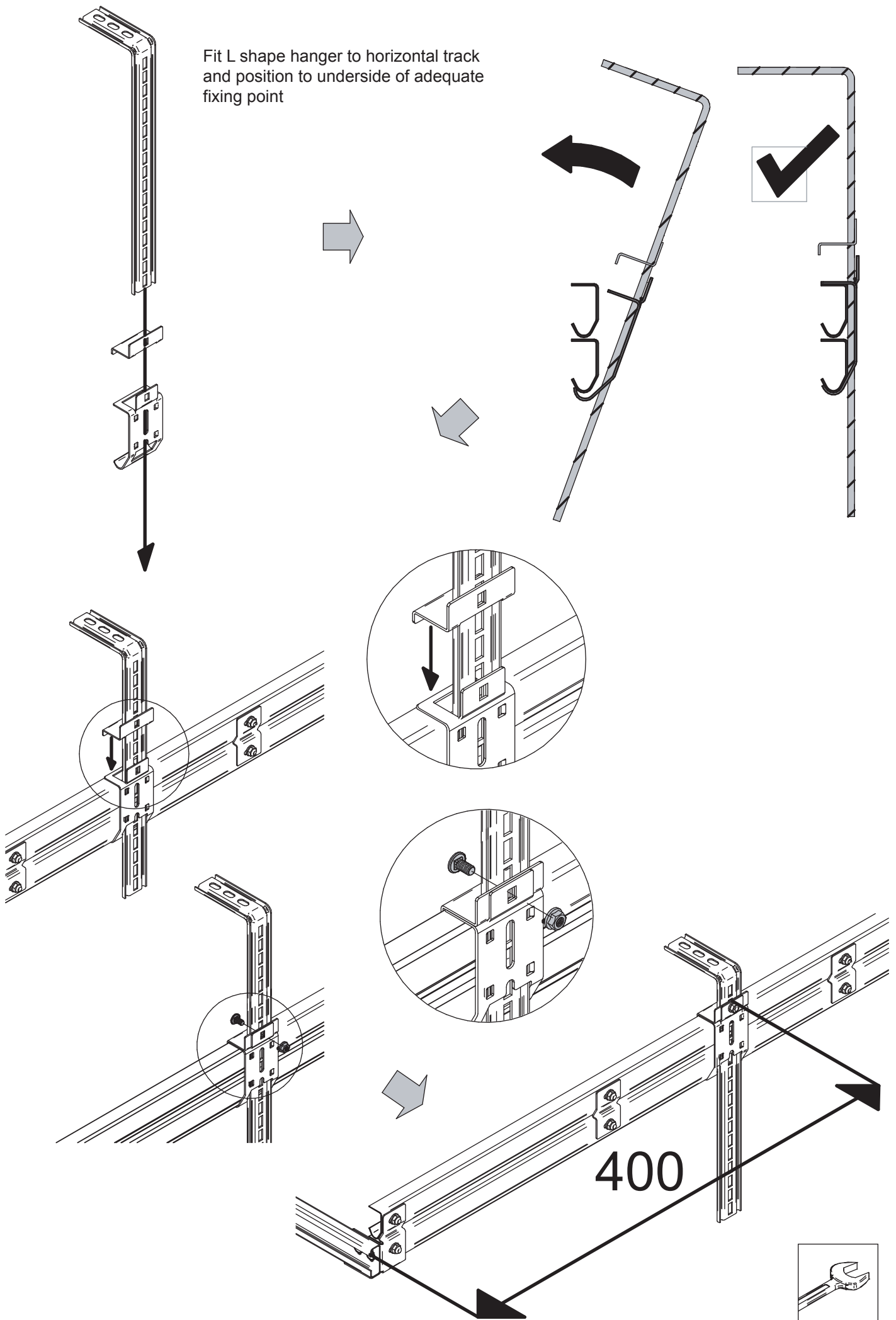

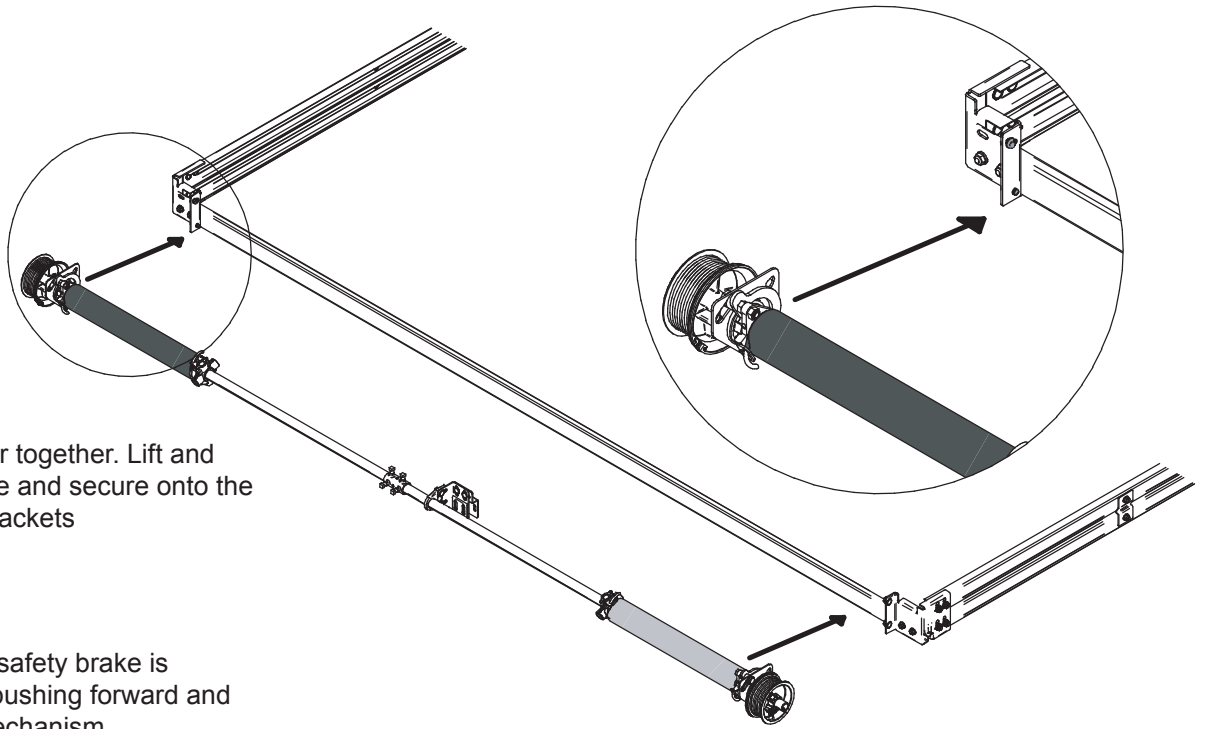

Join the front bar together. Lift and secure into place and secure onto the rear mounted brackets

Ensure that the safety brake is disengaged by pushing forward and releasing the mechanism

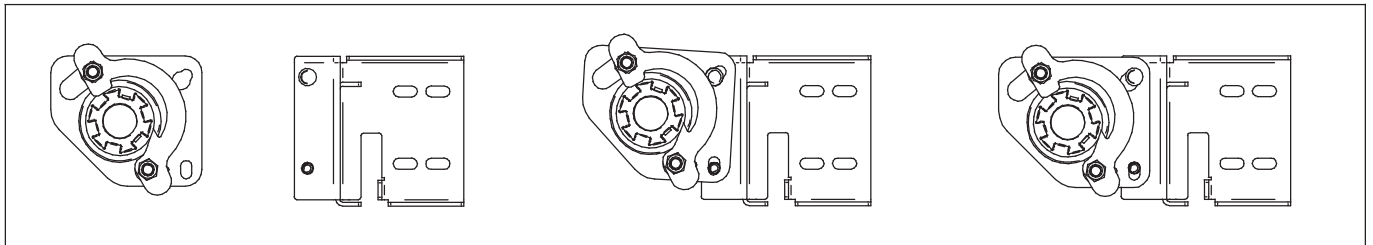

Secure spring assembly to back section using mounting parts shown

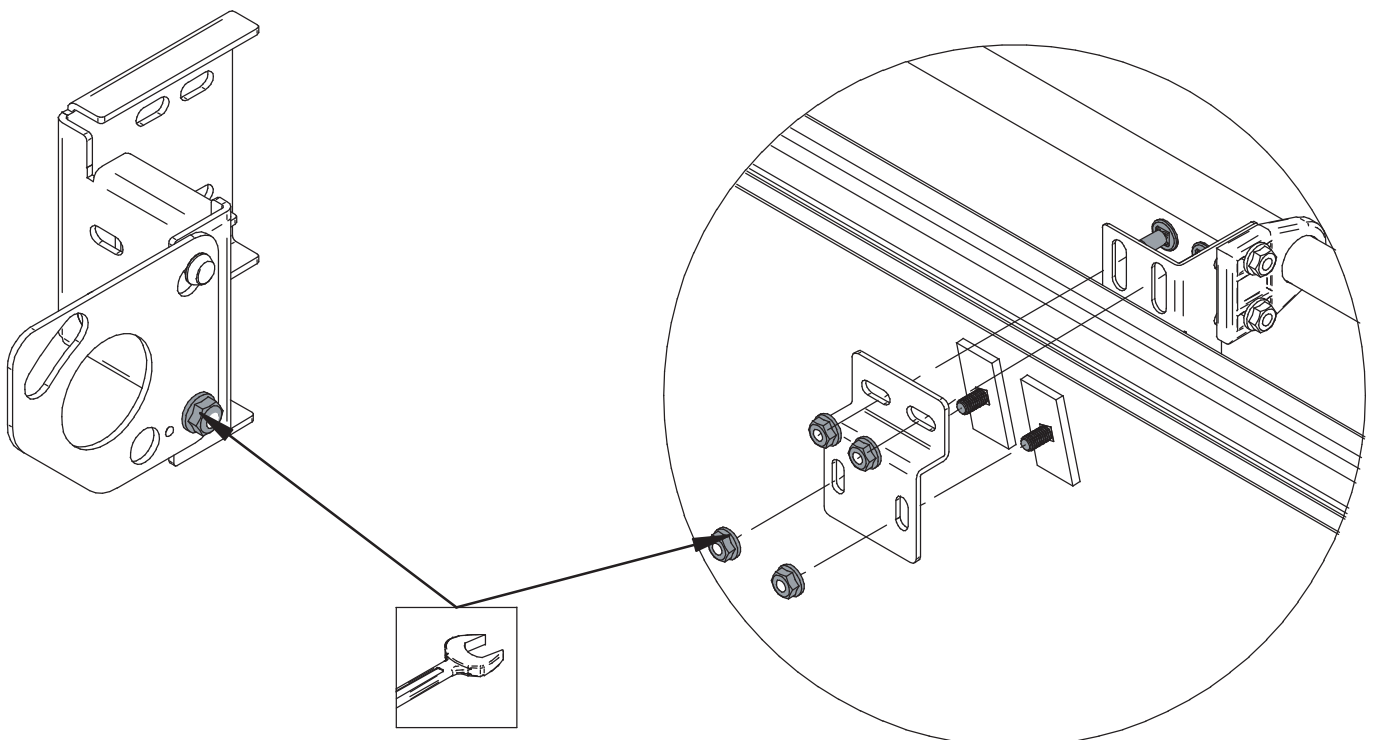

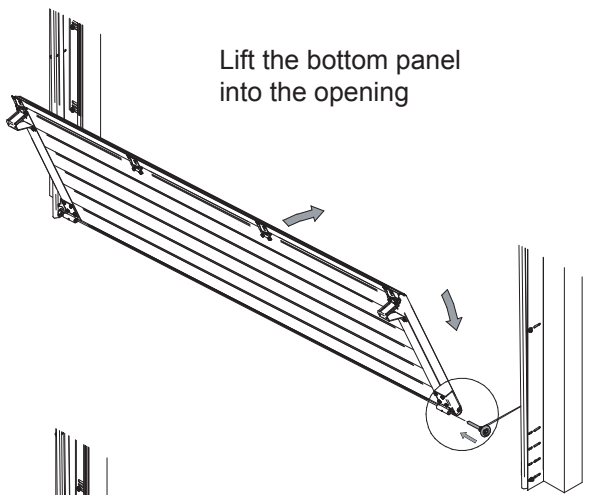

Fix bottom roller bracket

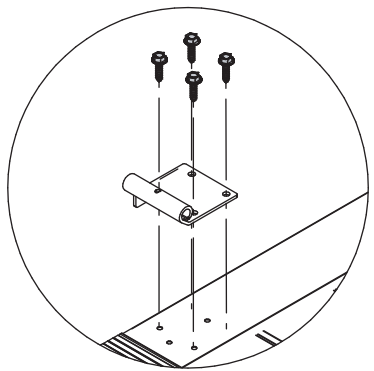

Connect the cables to the bottom roller bracket

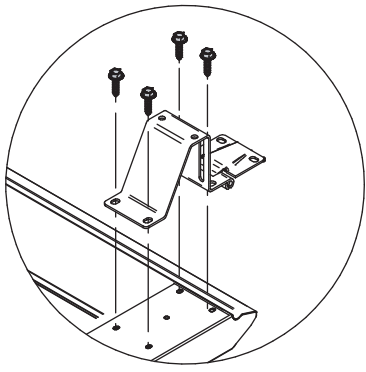
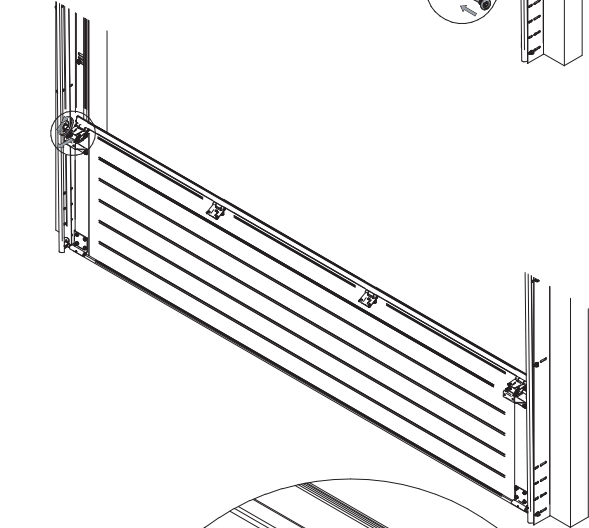
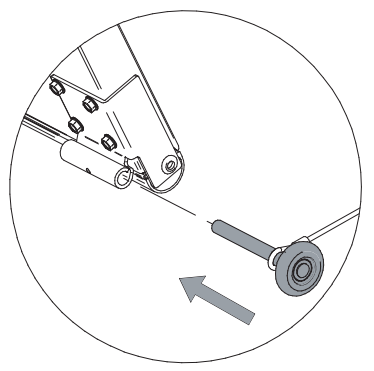

Prepare the sliding roller bracket with t-bolts and nuts

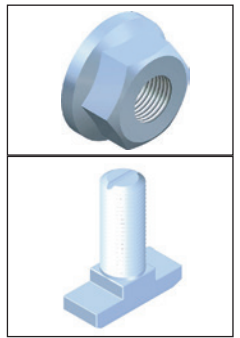
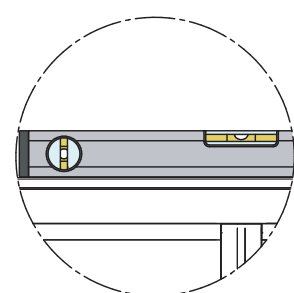
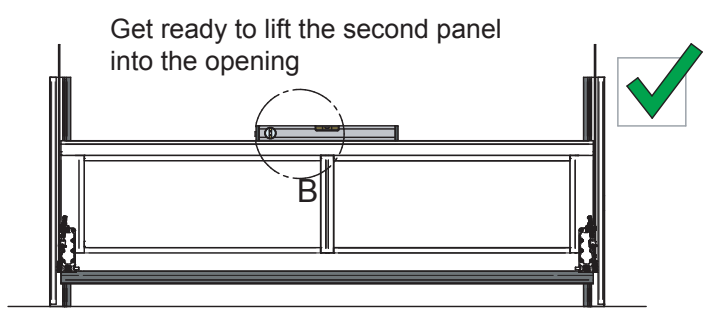
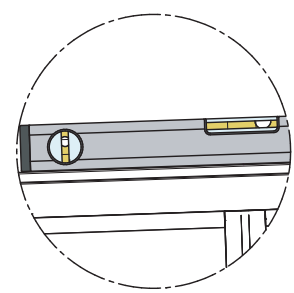
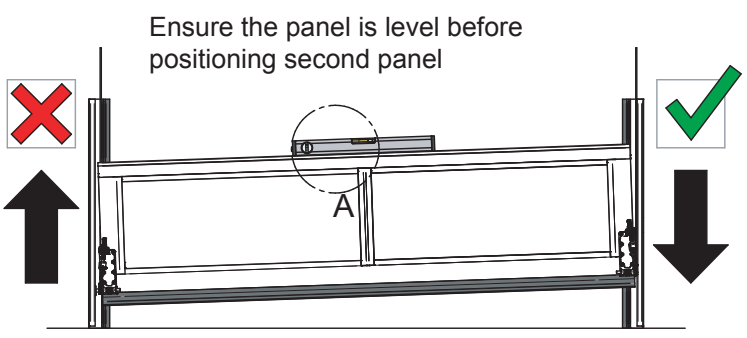
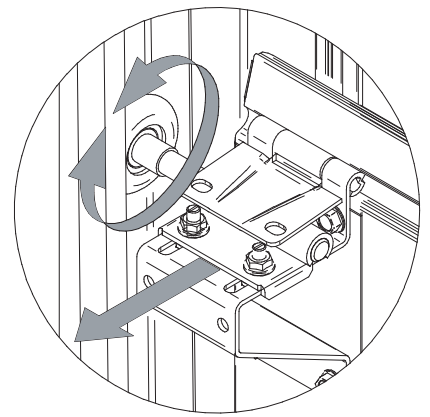
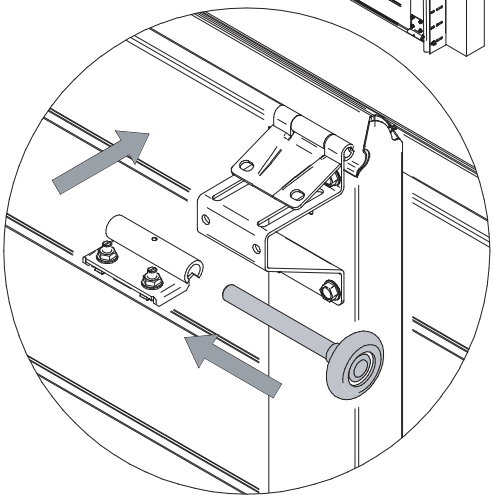
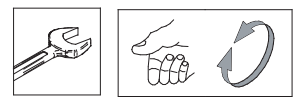
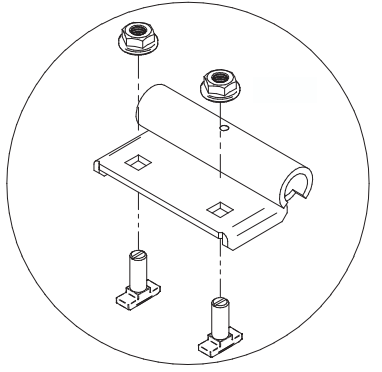

1

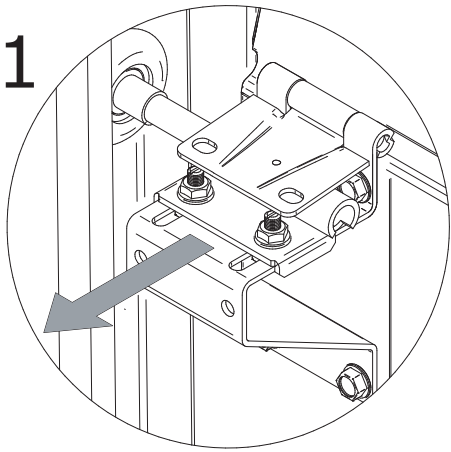

Lift the second panel into the opening and secure the brackets and roller as per panel one

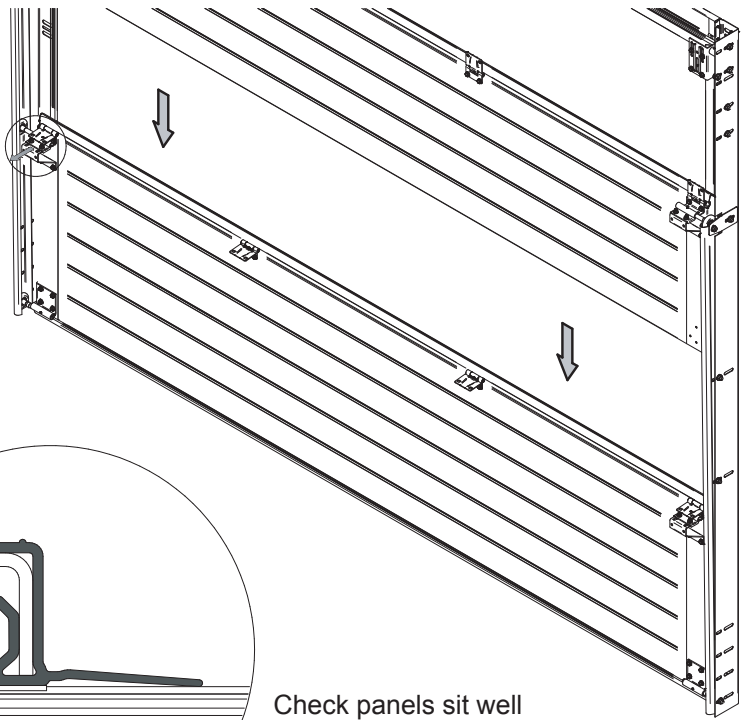

2

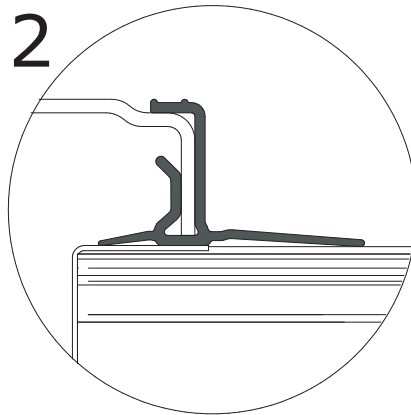

Check panels sit well with the weather seal on vertical tracks

3

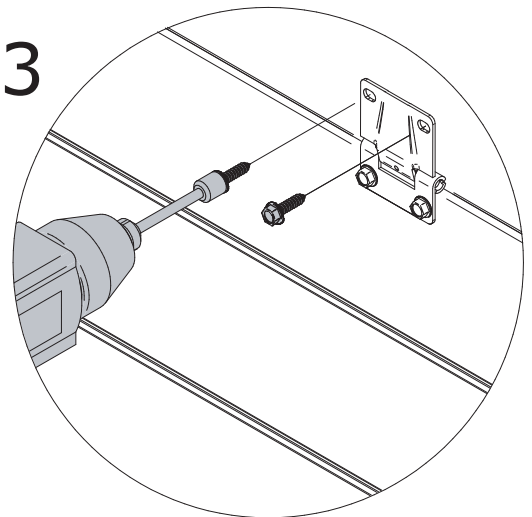

Secure central hinges

4

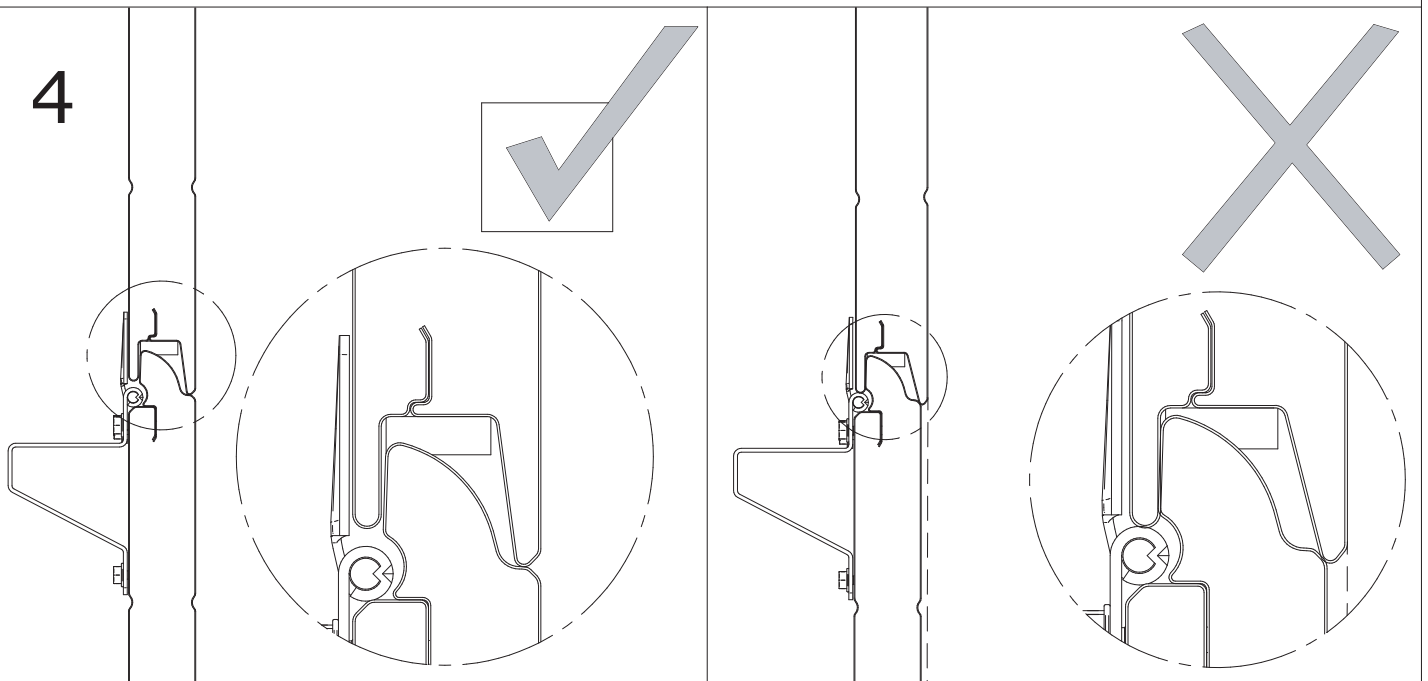

Add any remaining panels with the exception of the top panel

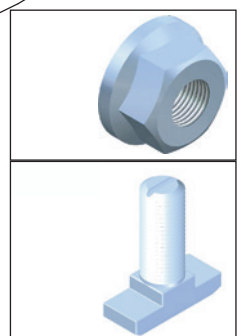
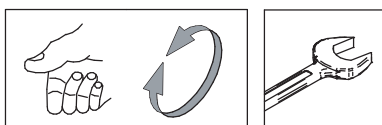
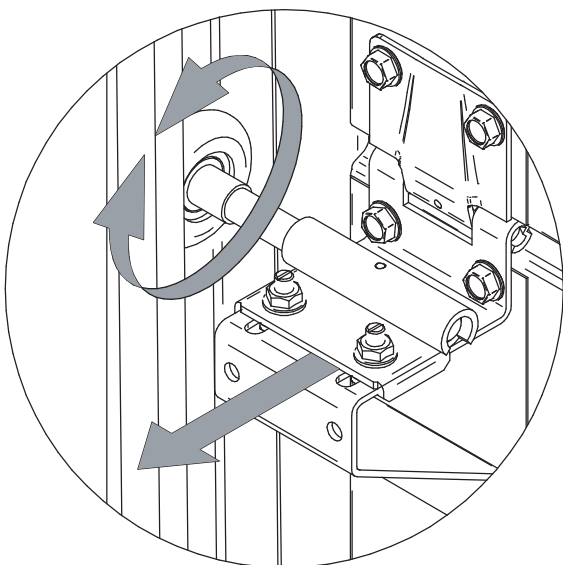
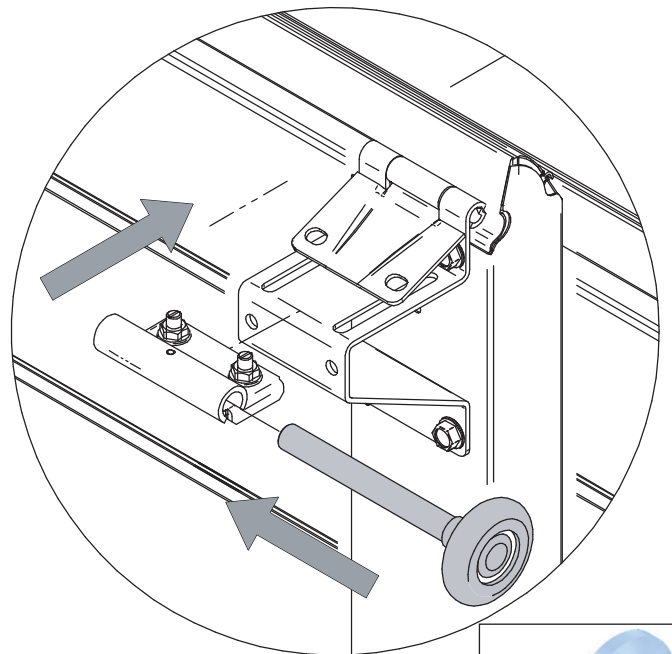
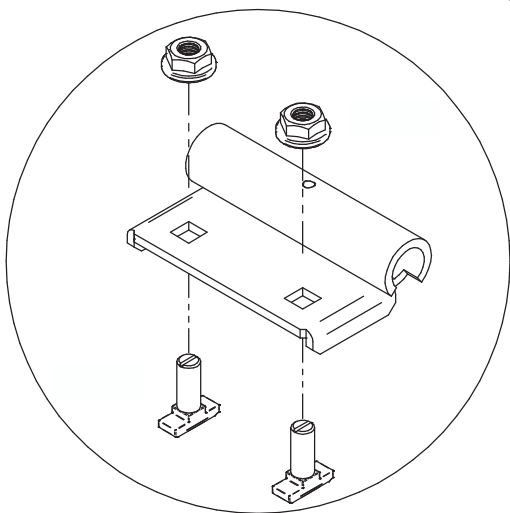
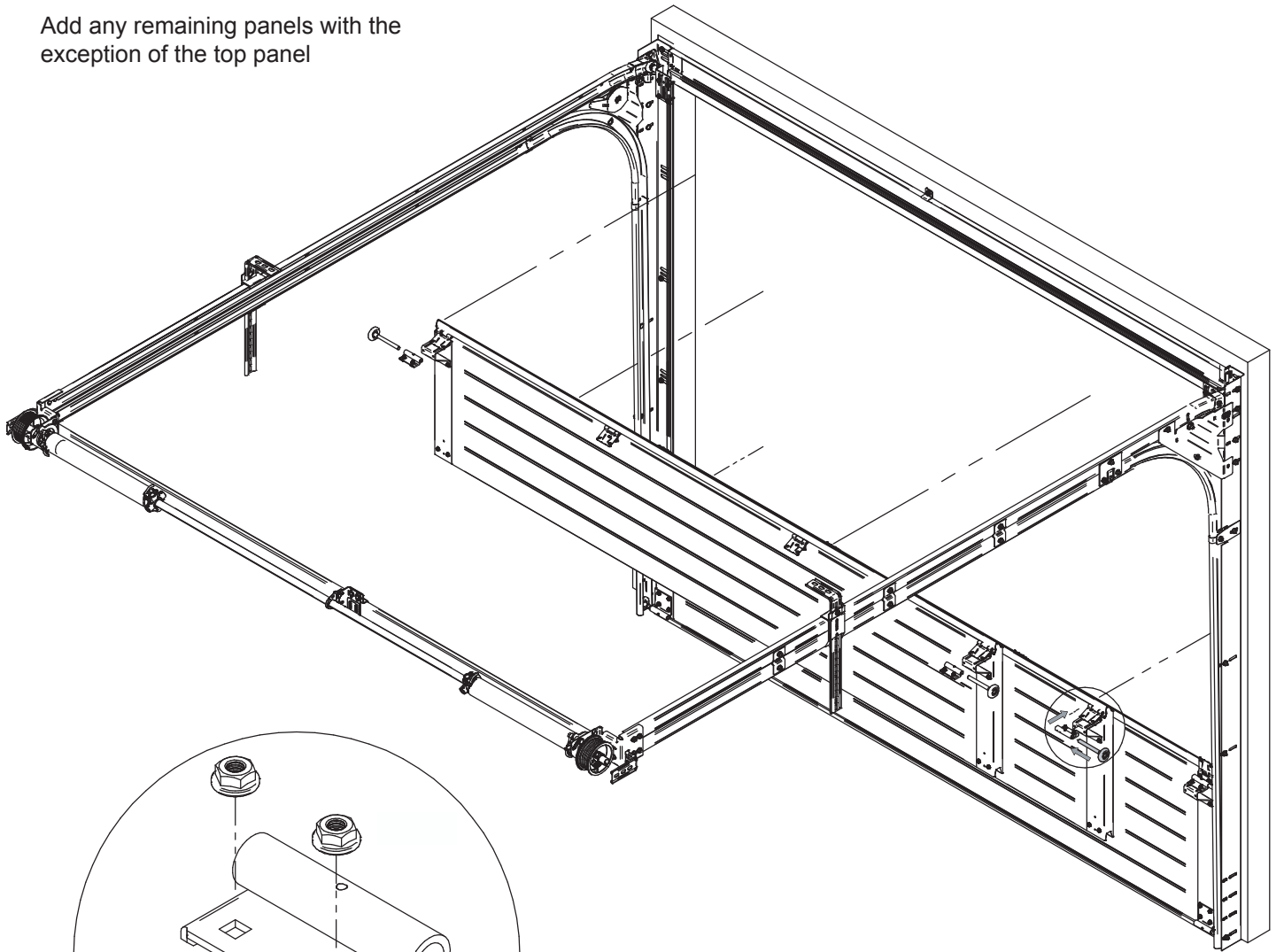

Lift top panel into opening

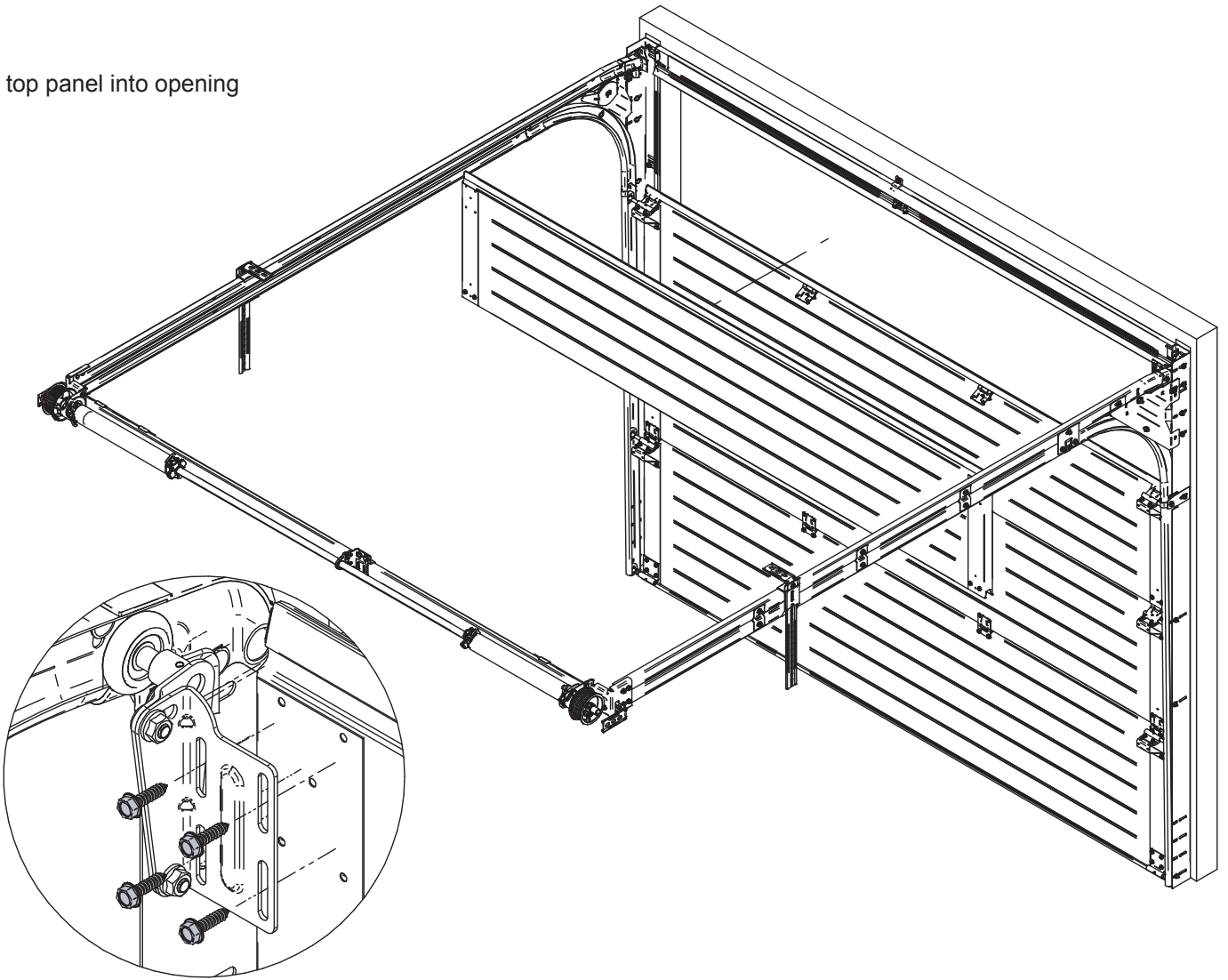

Secure the top roller brackets to the top panel

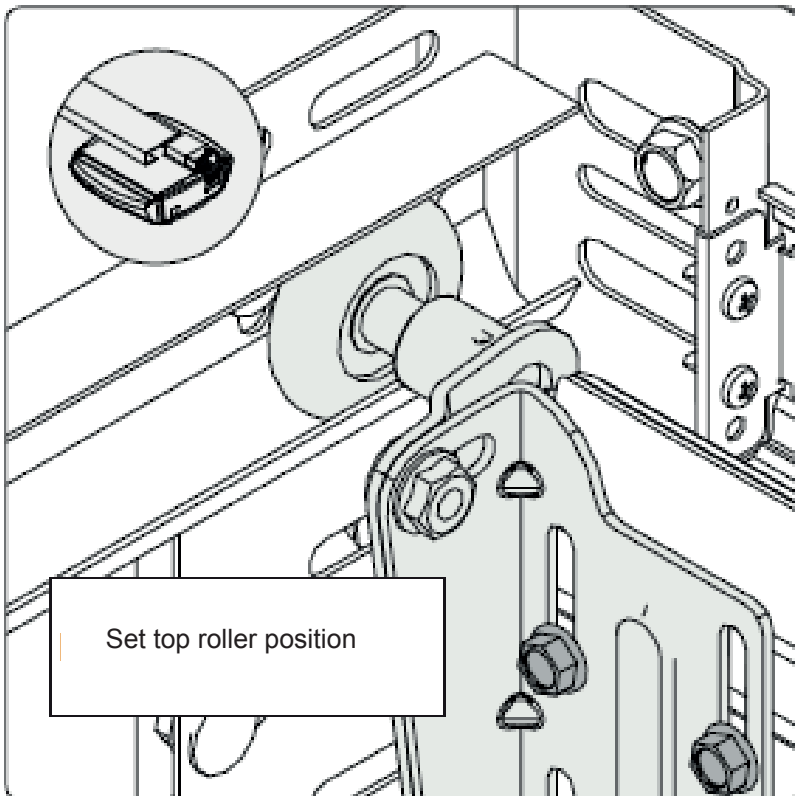

Ensure screws are tightened

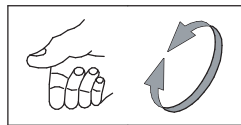
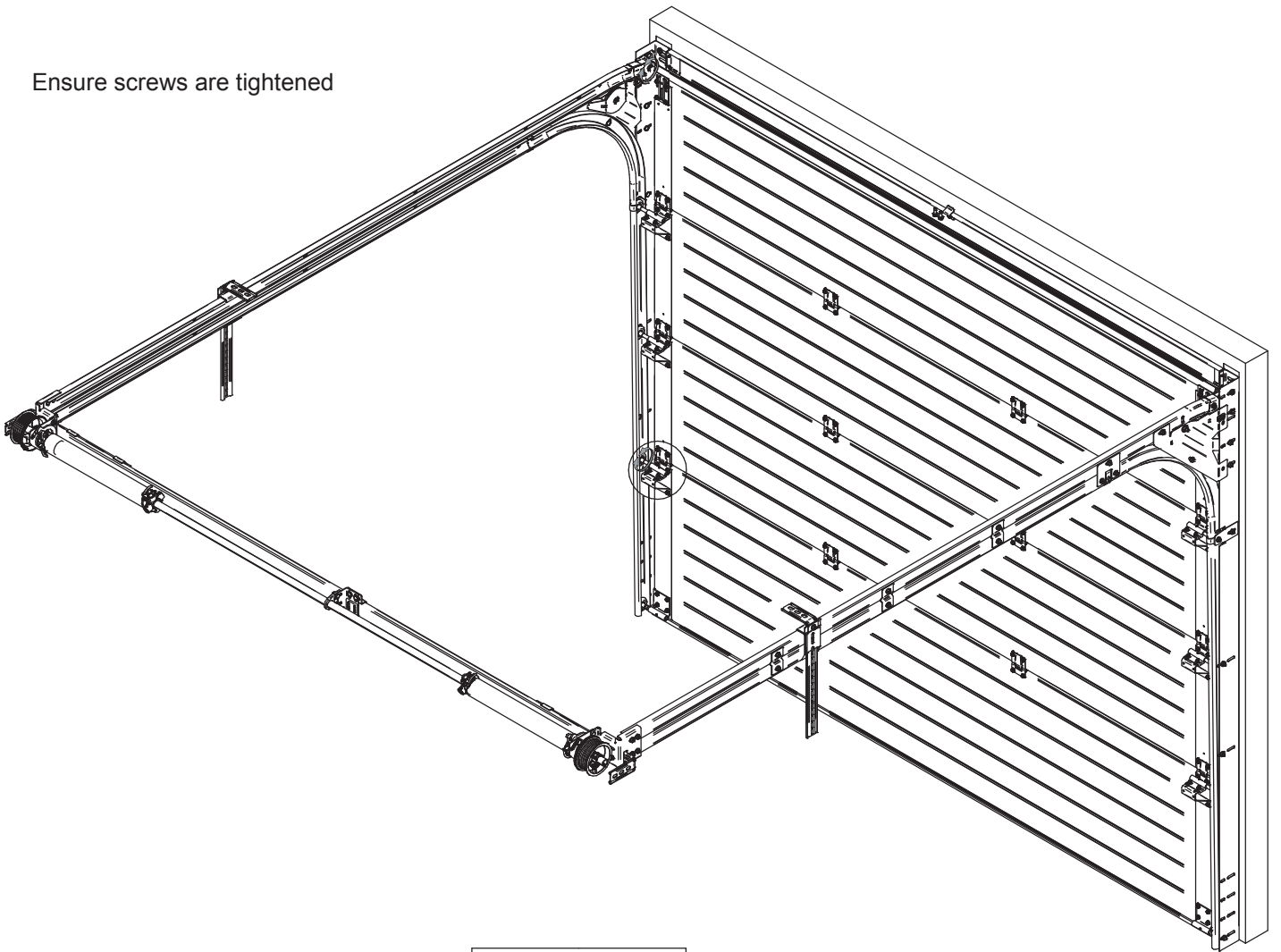

Ensure rollers are freely moving

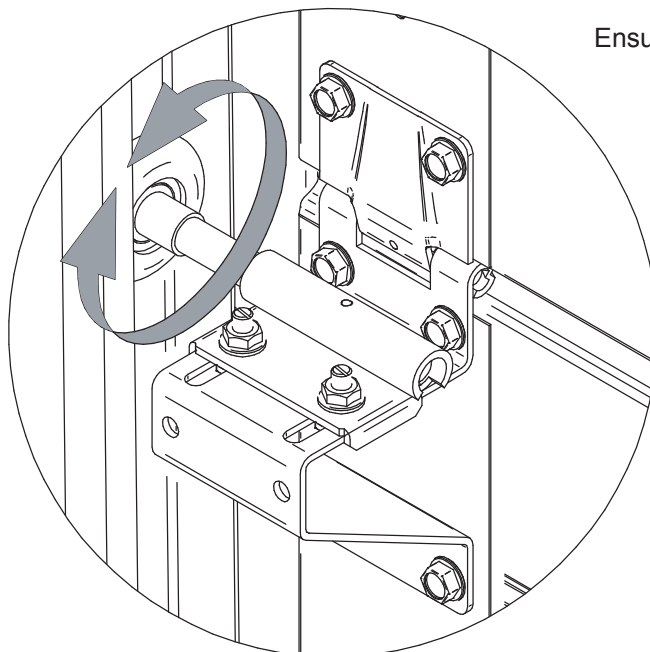



Before tensioning the door, clamp  
the panels into the down position

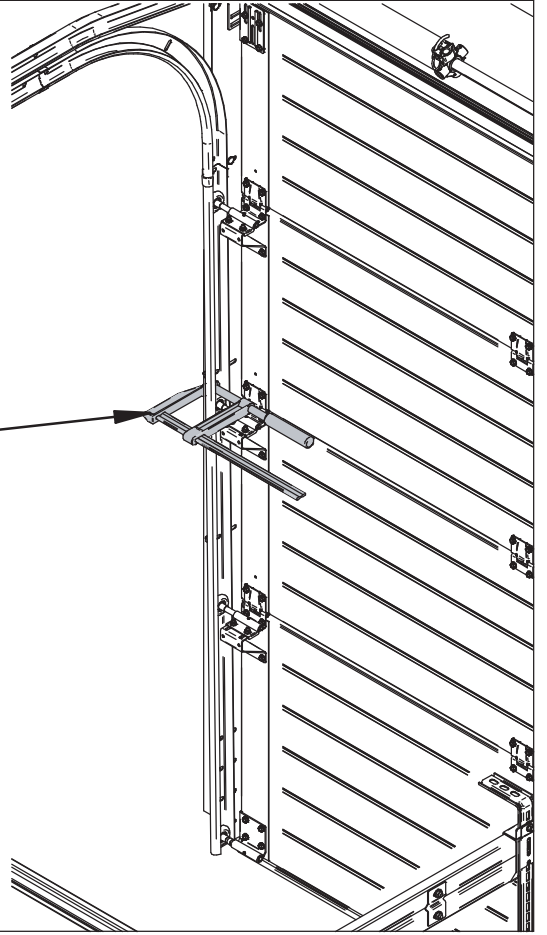
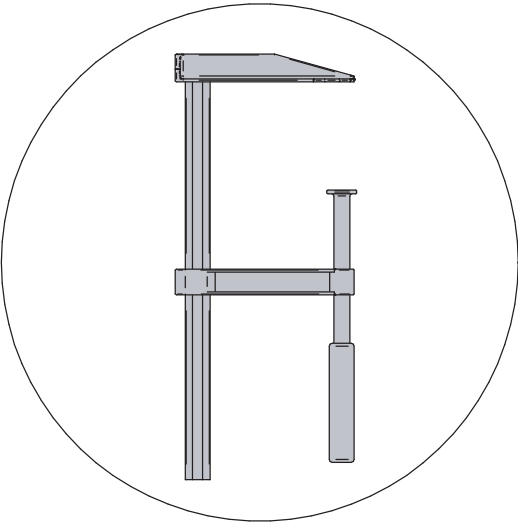

Ensure the cables are equally coiled around the drum

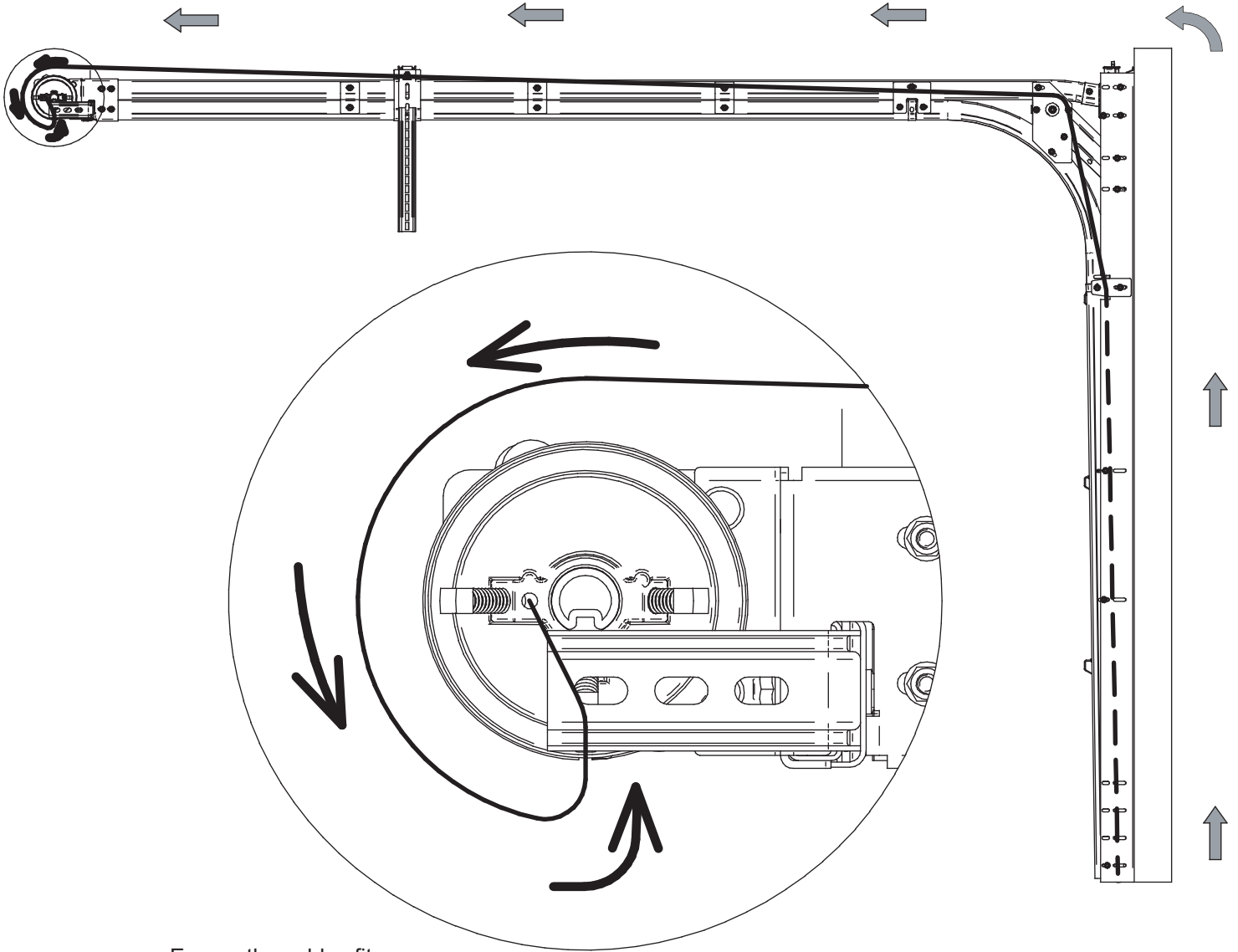

Ensure the cables fit neatly into the groove

When winding the cable onto the drum roller, please thread the cable from the rear of the drum and fasten off with the grub screw, allowing approx. 25mm of cable to protrude from the hole in the drum. Then wind the drum roller until the slack cable is around the drum, making sure you follow the grooves in the drum roller. Tensioning of the door can then begin as normal.

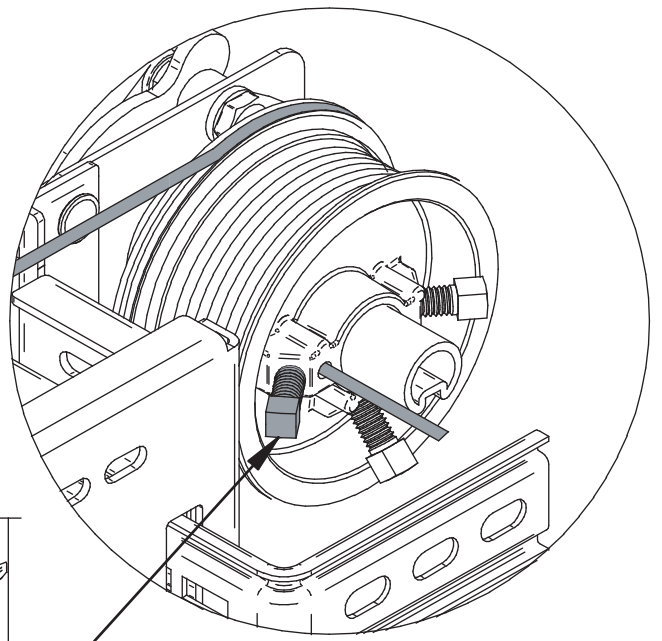
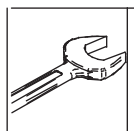
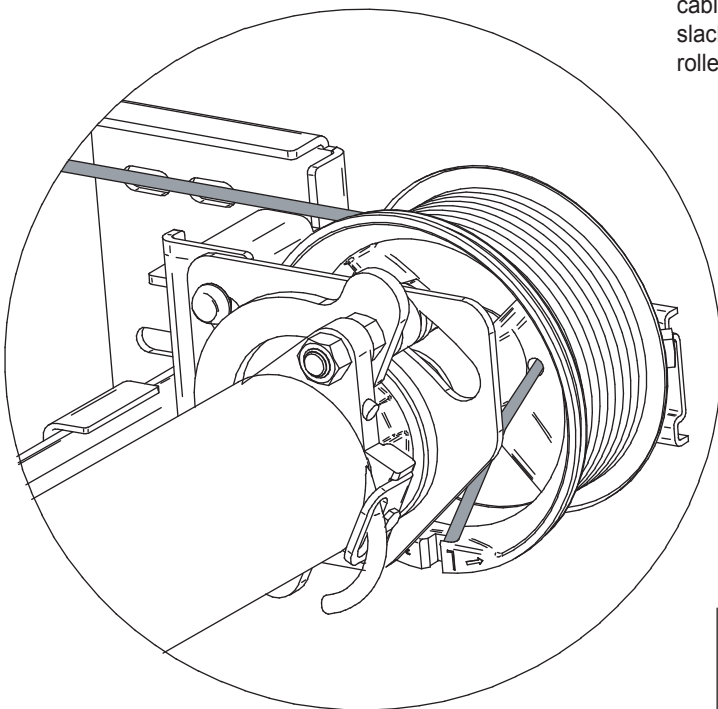

When tensioning the springs take great care, improper tensioning could lead to the tensioning bars striking your body.

Check paperwork or spring tension label found on the spring for number of turns.

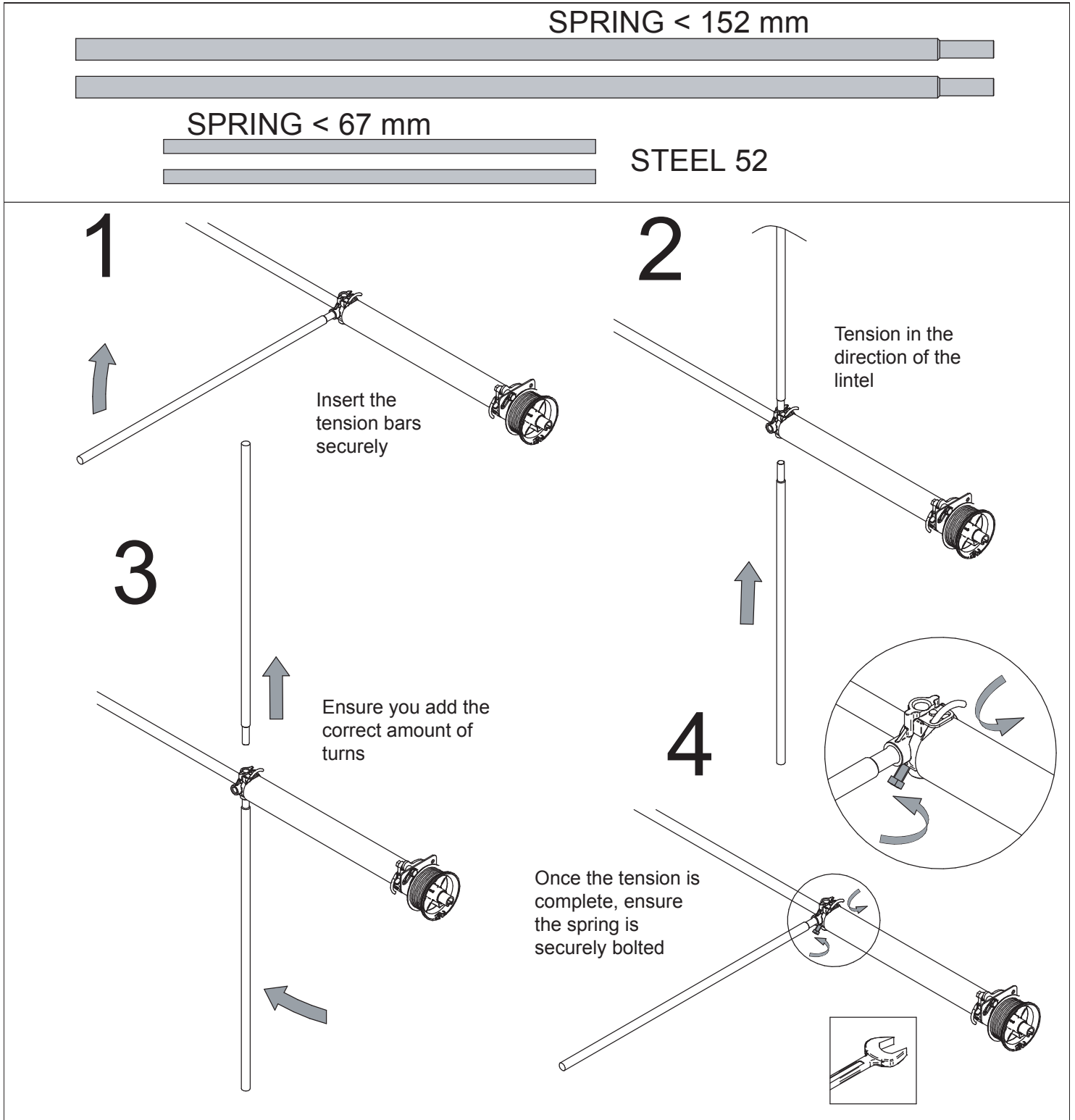

## Correct fastening of winding plug

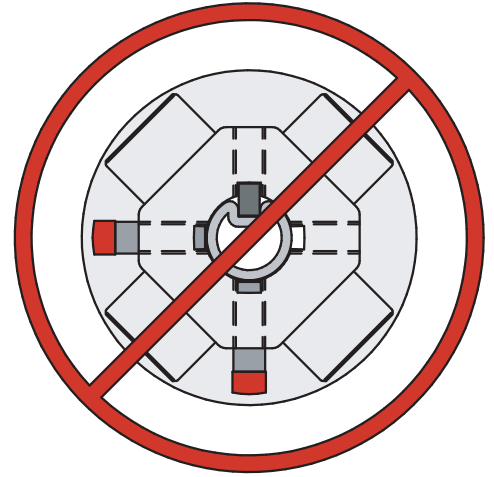
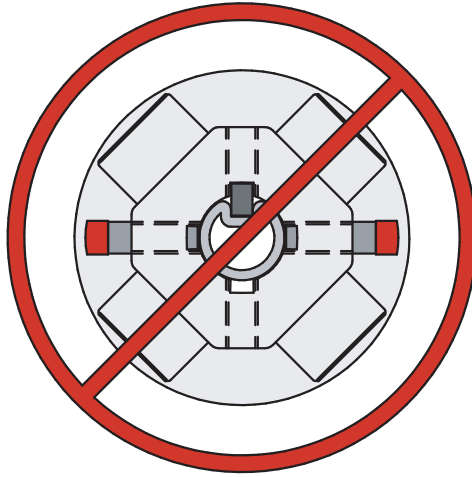
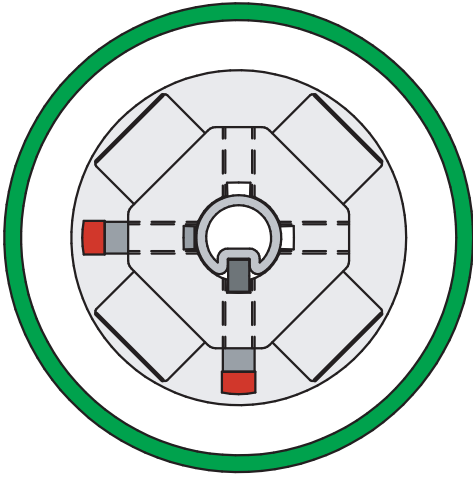

Ensure the locking bolts are pressing down on the key way

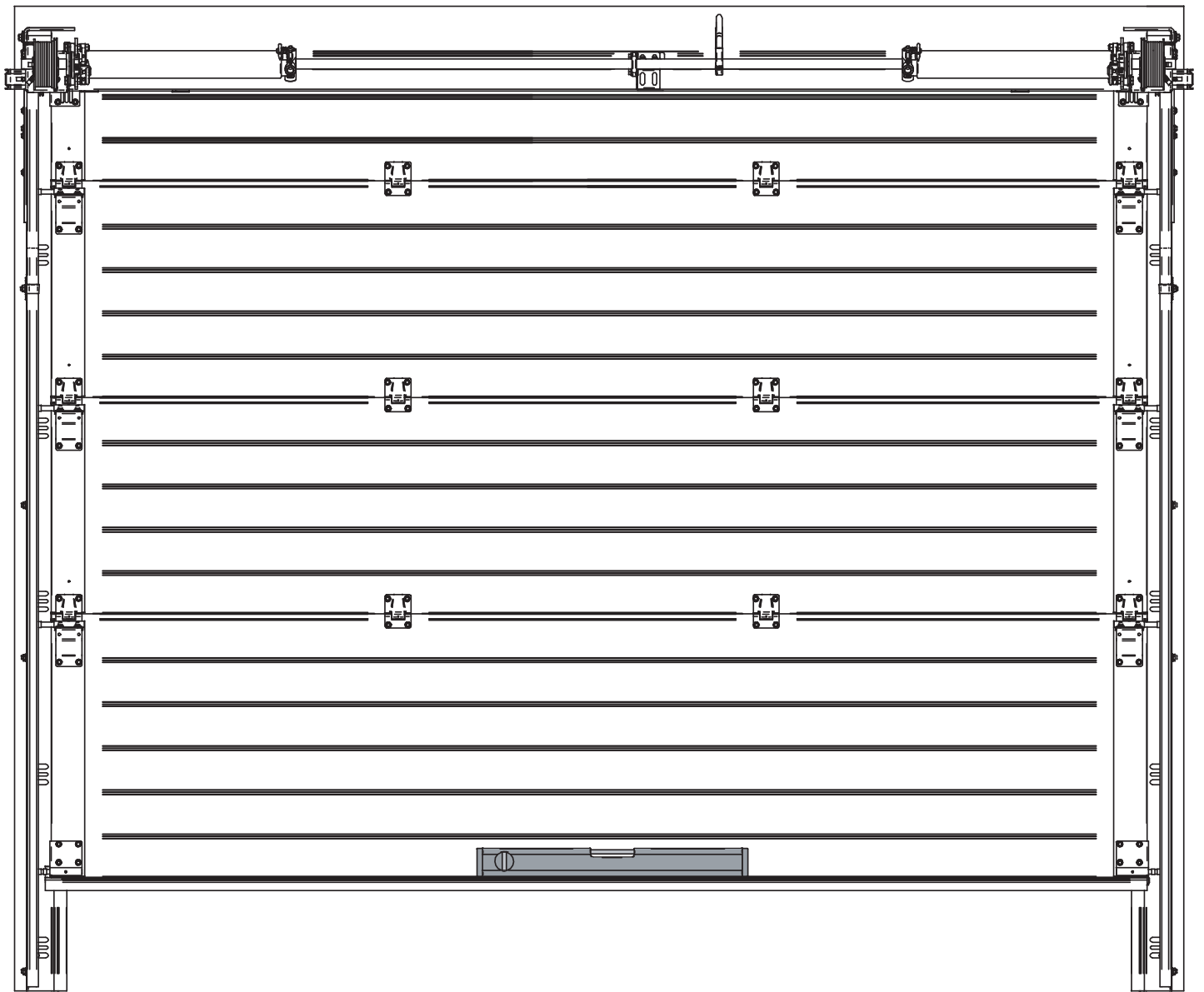

Once the tension is in place, check that the door is level. Check the balance and adjust if necessary

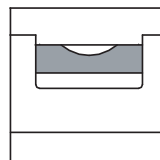
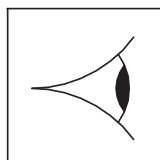

# Reveal Options

## Executive Framing Kit

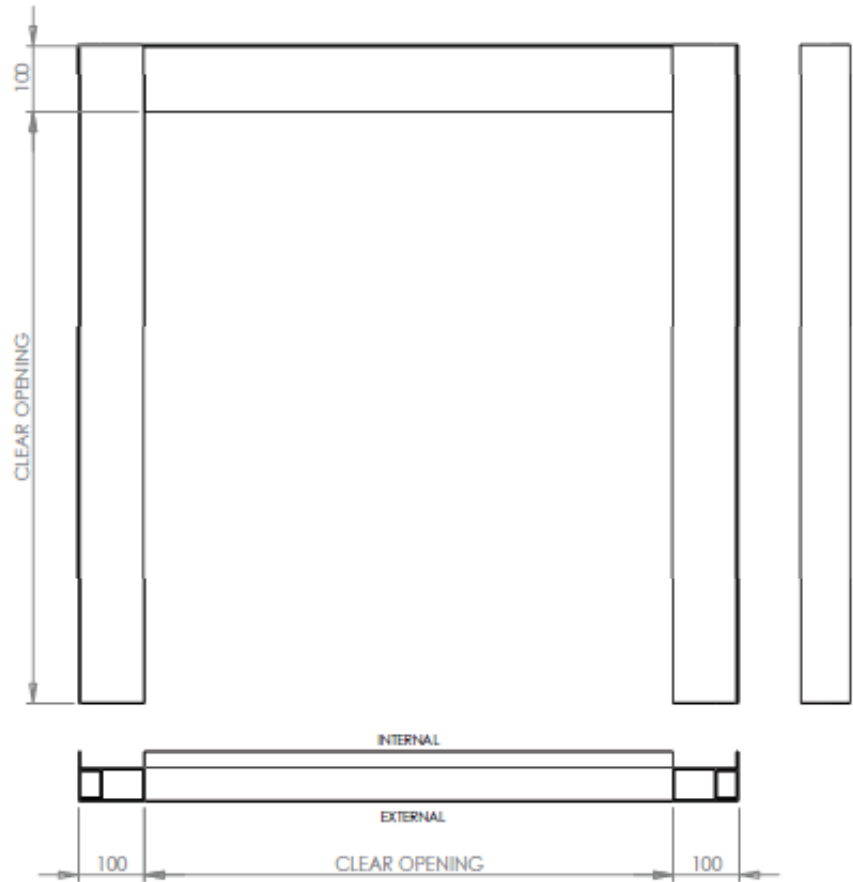
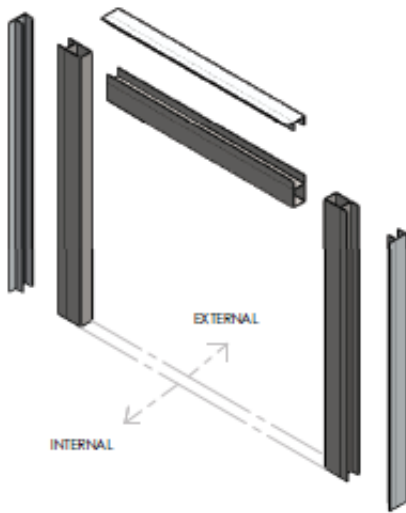
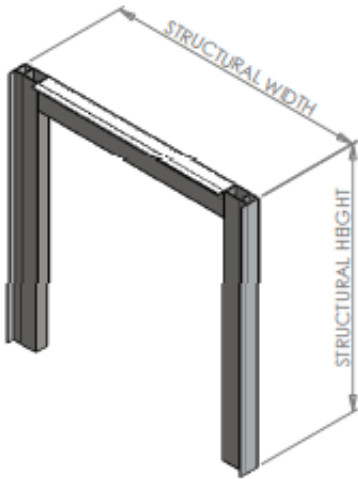

## Reveal Brackets

Position 5 per side, secure each bracket with 2 M8 x 18 bolts and M8 serrated nuts

