

Section
(scale 1:10)

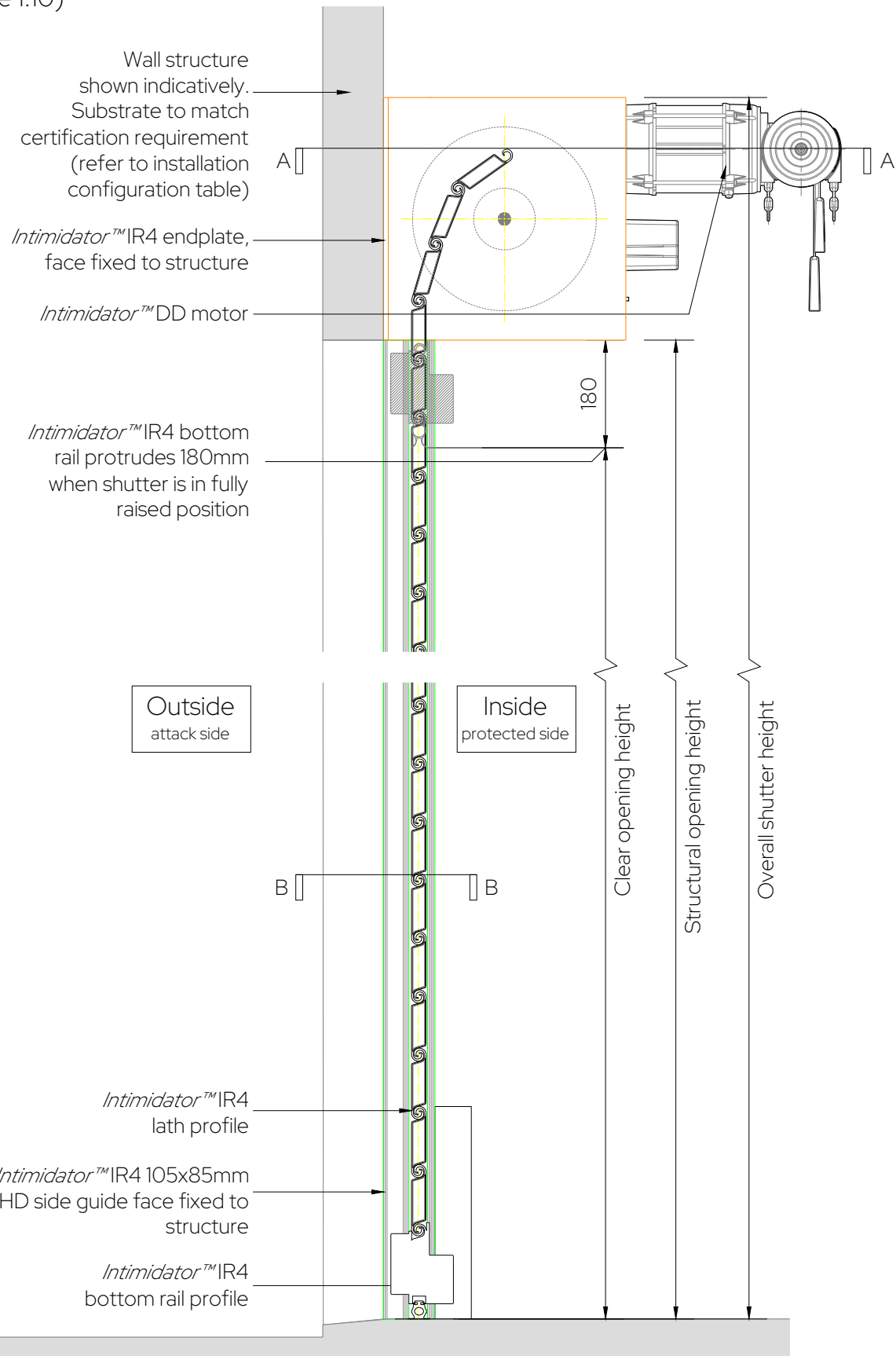

Plan Through: A-A
(scale 1:10)

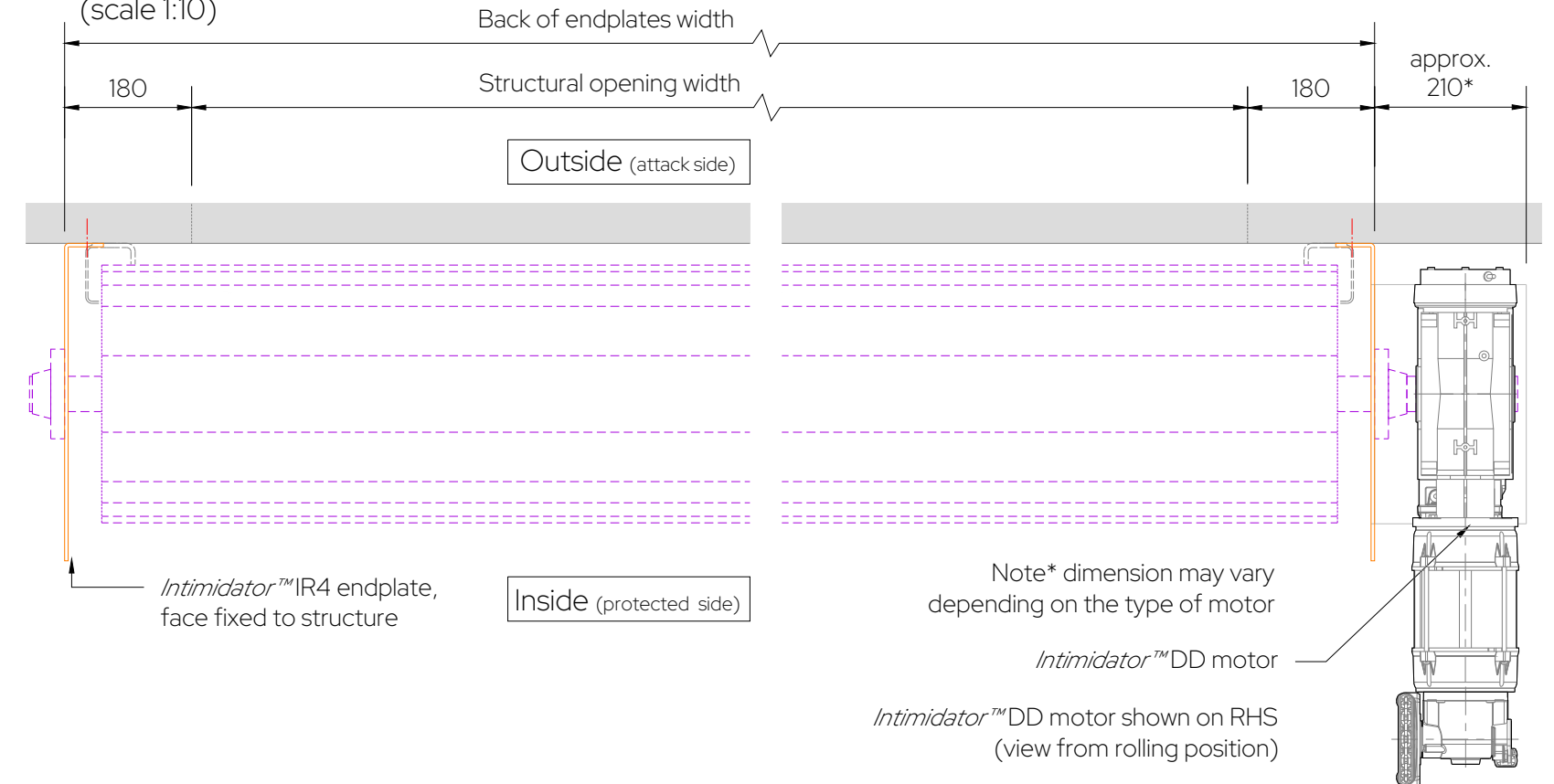

Plan Through: B-B
(scale 1:10)

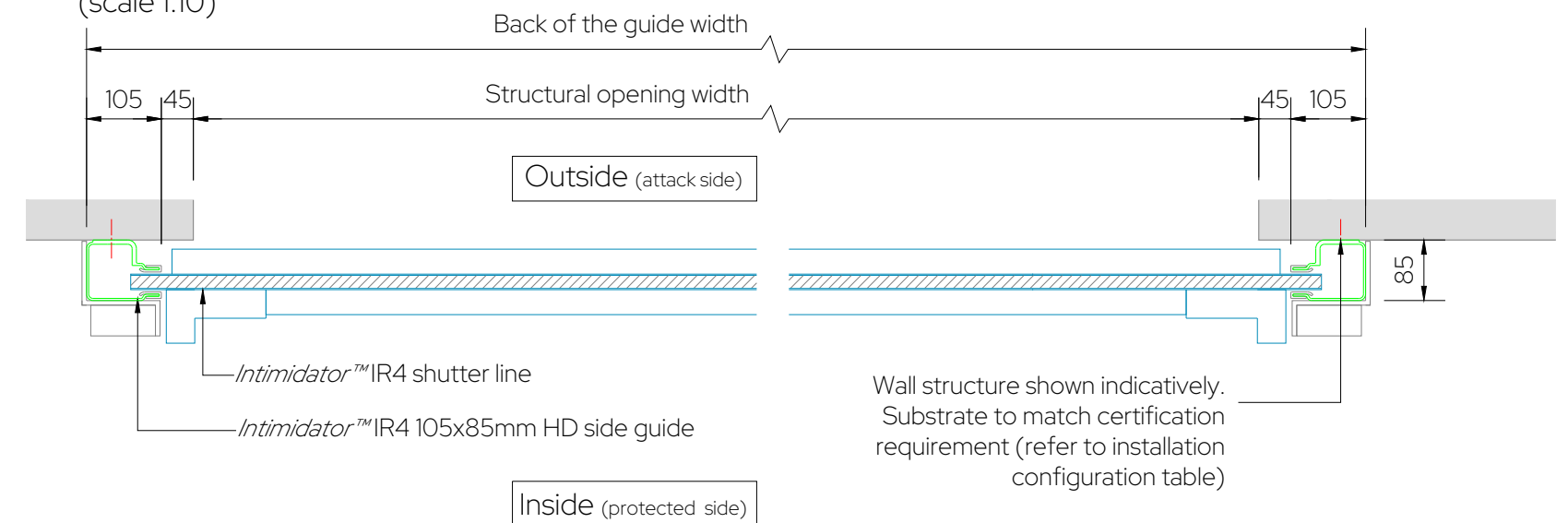

NOTES: This drawing is copyright of CGT Security Ltd and must not be reproduced whole or in part without prior written consent.

Shutter elevation - shown indicatively
(scale NTS)

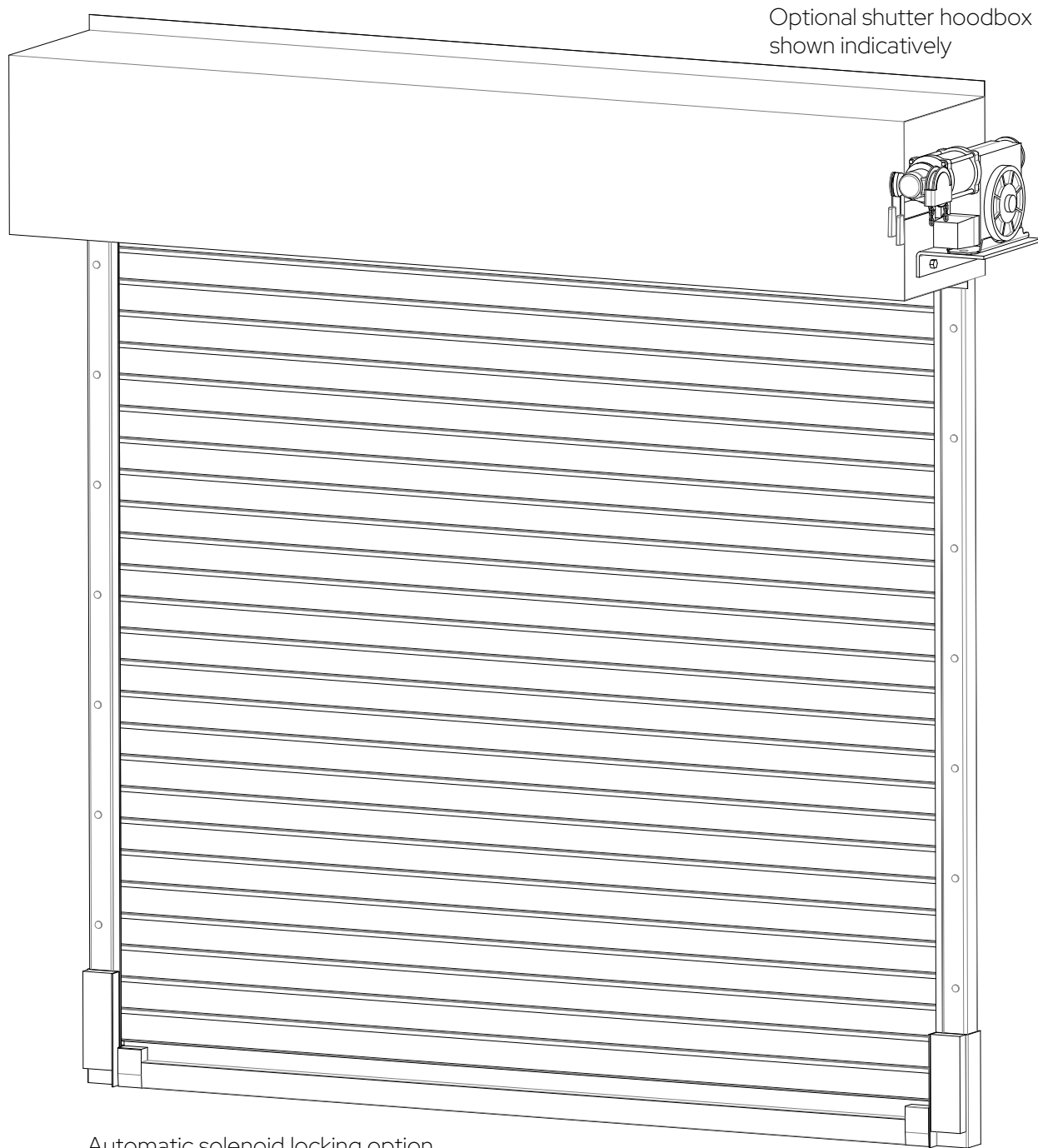

Optional shutter hoodbox
shown indicatively

Automatic solenoid locking option
shown indicatively

Intimidator™ IR4 lath profile
(scale 1:10)

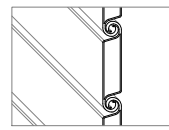

Double skin
solid lath

Intimidator™ IR4 locking options
(scale 1:10)

section

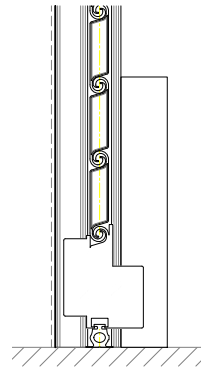

Automatic solenoid locking option

plan view

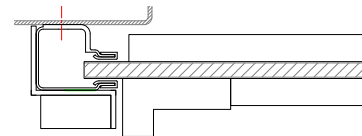

section

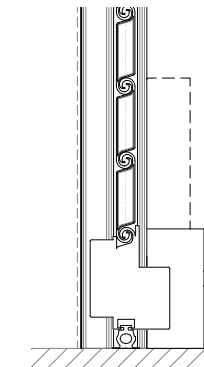

Slide bolt lock option

plan view

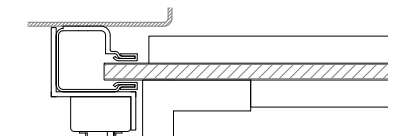

INTIMIDATOR™ IR4 SPECIALIST ROLLER SHUTTER SYSTEMS

Security Rating	Minimum structural opening width	Maximum structural opening width	Minimum structural opening height	Maximum structural opening height
D10 (SR4)	1750mm	8000mm	1000mm	8000mm

NOTE: The installation shall be direct to the substrate and not via intermediate substrates, such as plasterboard

Installation Configurations

Configuration				
Internally face fitted roller shutter	Reinforced brickwork	Reinforced blockwork	Reinforced concrete	Steel (Minimum 5mm thickness and 150mm wide)
	✓	✓	✓	✓

NOTES: This drawing is copyright of CGT Security Ltd and must not be reproduced whole or in part without prior written consent.