

Section
(scale 1:10)

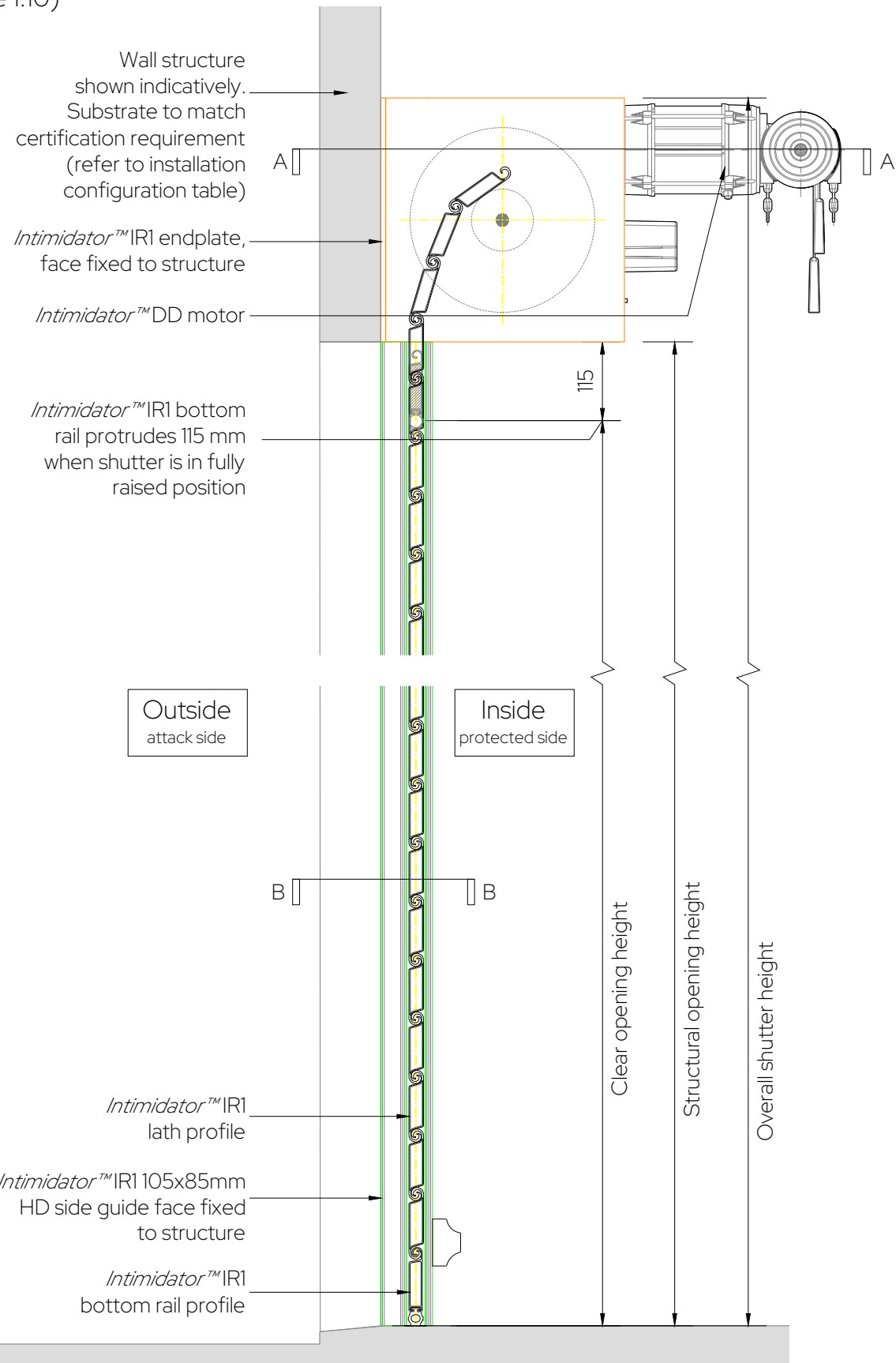

Plan Through: A-A
(scale 1:10)

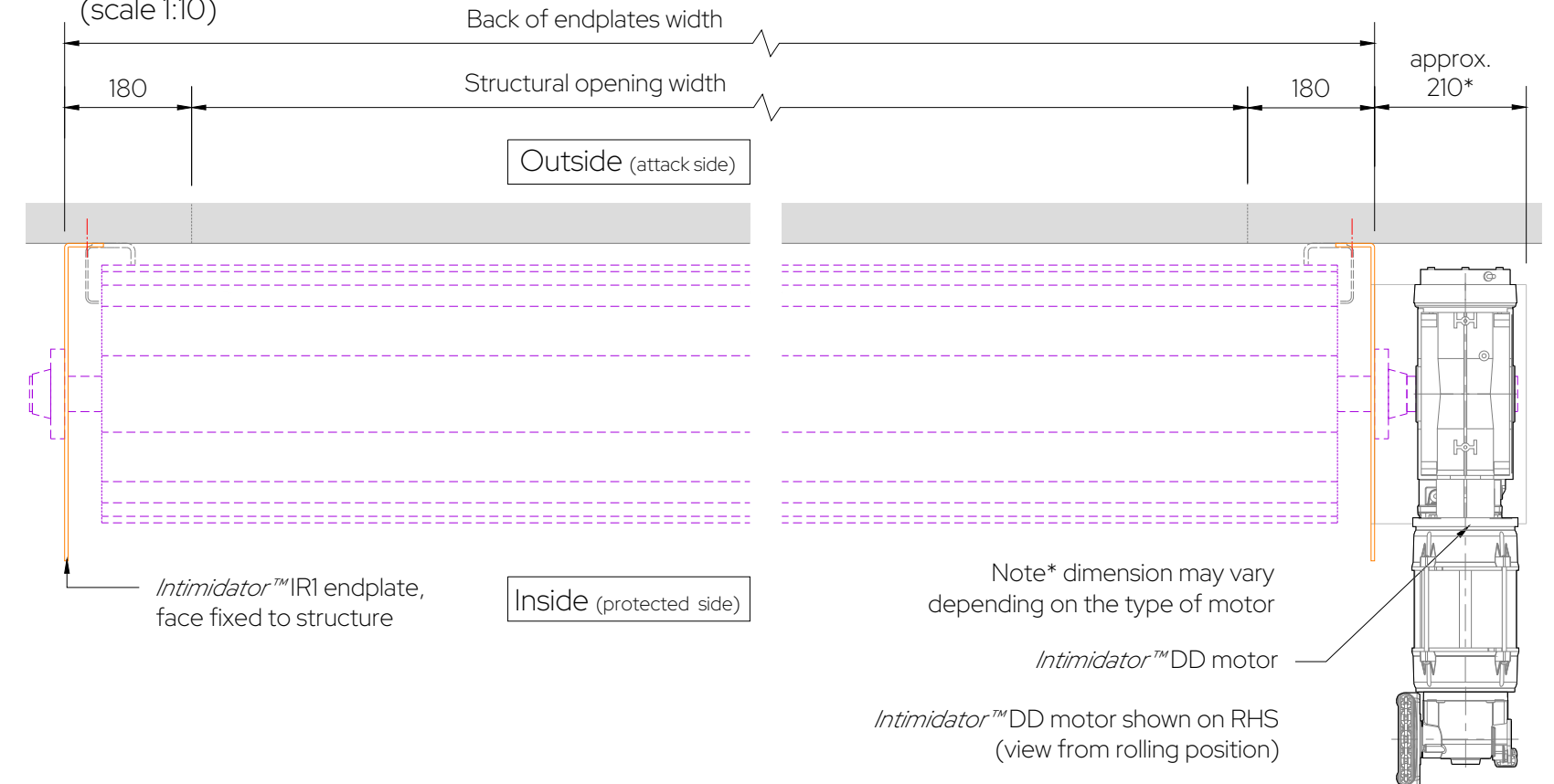

Plan Through: B-B
(scale 1:10)

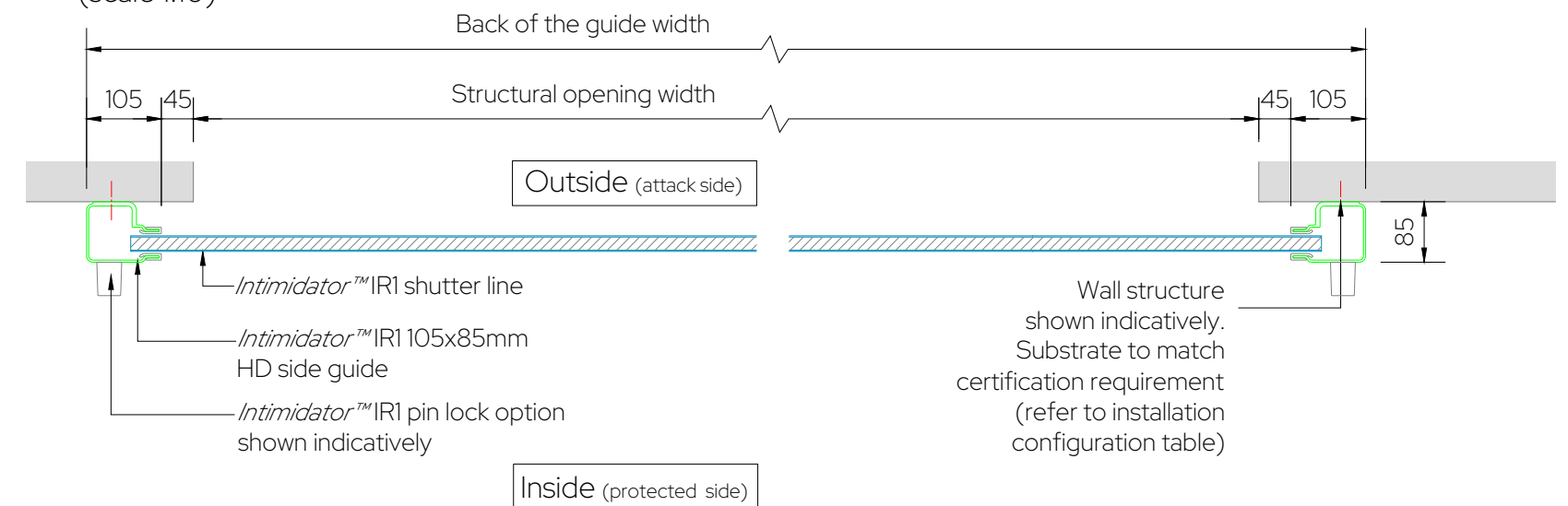

NOTES: This drawing is copyright of CGT Security Ltd and must not be reproduced whole or in part without prior written consent.

Shutter elevation - shown indicatively
(scale NTS)



Intimidator™ IRI lath profiles
(scale 1:10)

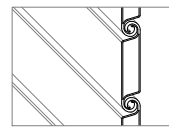

Double skin solid lath

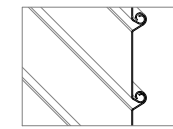

Single skin solid/perforated lath

Intimidator™ IRI locking options
(scale 1:10)

section

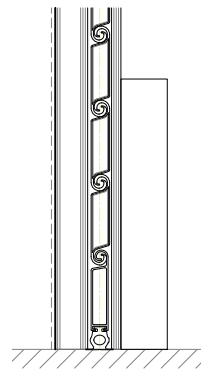

Automatic solenoid locking option

plan view

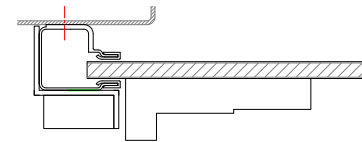

section

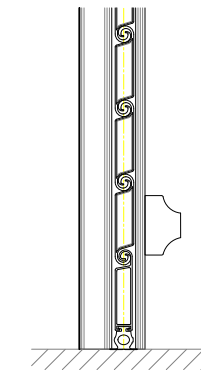

Manual pin lock option

plan view

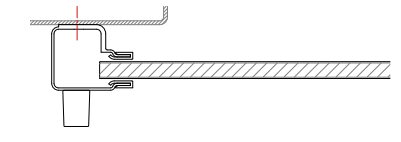

INTIMIDATOR™ IRI SPECIALIST ROLLER SHUTTER SYSTEMS

Security Rating	Minimum structural opening width	Maximum structural opening width	Minimum structural opening height	Maximum structural opening height
A1 (SRI)	1000mm	8000mm	1000mm	8000mm
A1 (SRI) perforated	1000mm	8000mm	1000mm	8000mm

NOTE: The installation shall be direct to the substrate and not via intermediate substrates, such as plasterboard

Installation Configurations

Configuration	Substrate				
	Structural Timber (minimum 150mm wide)	Brickwork	Blockwork	Concrete	Steel (Minimum 3mm thickness and 150mm wide)
Internally face fitted roller shutter	✓	✓	✓	✓	✓

NOTES: This drawing is copyright of CGT Security Ltd and must not be reproduced whole or in part without prior written consent.