



Security Direct
property protection

- Large Product Range ✓
- Competitive Prices ✓
- 25 years Experience ✓

Fire Rated Curtain



SECURITY DIRECT
www.securitydirectuk.com

Fire Curtains - 120min



Key Benefits

- Kitchen Serveries, Reception Counters, Residential, Lifts
- Tested and Certified to Bs476 and BS EN 1634
- Fire Rating - 120mins
- Grey Kevlar Fabric Curtain
- Up to 6m wide openings
- Compact Shutter Box and Guides
- Single Phase Tube Motor
- Fully automated controls available
- Powder Coated White as standard
- 3 week lead time (Subject to change)

Fire Curtains - 120min



Product Overview

Description

Fire Curtains are designed to stop the spread of fire for up to 2 hours. They are common on Reception Counters, Kitchen Serveries, Stores, Lifts and open plan residential applications. The advantage of a Fire Curtain is that it has a Fabric Kevlar curtain, which means it coils into a smaller box, compared with a Fire Shutter. This is ideal when you are limited on headroom. A fire curtain is designed to be in the up position at all times and it will only close in a fire situation. The shutters have been independently tested and certified by Exova to Fire Standards BS476 and BS EN 1634.

Common use

Kitchen Serveries, Reception Counters, Residential, Lifts

Maximum Width

6000mm

Maximum Height

5000mm

Weight

8kgs m/2

Standard Finish

CURTAIN - Grey Kevlar

BOX & GUIDES - Powder Coated White as standard. Powder Coating a BS or RAL colours are available at an extra cost.

Lead Time

15 working days (subject to change)

Fire Curtains - 120min



Specification

CURTAIN SLAT

Curtain is constructed of a stainless steel wire reinforced glass fabric intended for applications exposed to high temperatures. Grey Finish as standard.



SHUTTER BOX

3mm Galvanised steel end plates with galvanised steel 3 side hood as standard. Hoods will be supplied in sleeved sections which will need to be joined on site during the installation. Alternatively hoods can be supplied in one section up to 6m long but this will extend production time and delivery costs. Fascias and 2 sided hoods are available at no extra charge.

Box Sizes

200 mm - 220 mm - As this varies depending on the height

GUIDE RAILS

.100 mm x 55 mm deep two piece galvanised steel guide assembly which can be face or reveal fixed. The guide rails are designed to allow for expansion when acting as a fire barrier. The guide rail consists of an inner section which is face or reveal fixed into position. The outer section conceals the fixings and is fixed to the inner section with rivet nuts.

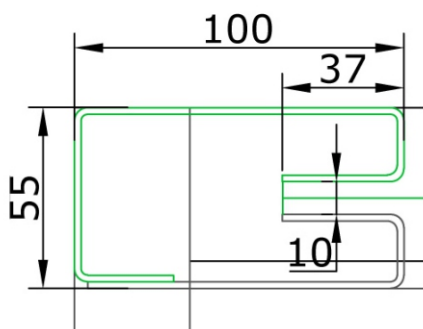

Fire Curtains - 120min



Specification

OPERATION

The Fire Curtain is powered using a 24V DC tubular motor which is supplied as standard with a 4m 7 core cable. This product is not designed for frequent use. This product is designed to remain open during normal use and only to be closed during a test or an emergency situation. The motor and control panel features controlled descent or gravity fail safe in the event of a signal or fire alarm or power failure.



DELUXE CONTROL PANEL -

The advanced control panel includes;

- Fire Alarm Input
- Emergency Override input for Emergency Escape or Firemans Switch
- Audio/Visual Output
- 24v Battery Backup
- Split Drop of curtain to allow emergency access
- Low Battery automatic close feature
- Group Control facility
- Safety Device inputs
- Integrated Radio Receiver