

INSTALLATION GUIDE

Please read these instructions carefully before connecting the receiver.

1. Characteristics:

- (1) Both 115 VAC and 220VAC models are available. Before connecting the receiver to the power supply verify that you have the proper units
- (2) Operating temperature: -10°C - 50°C (14°F - 122°F)
- (3) This is a radio frequency controller operating at 433MHz

2. Recommendations for Mounting of the Receiver:

- (1) The receiver should be mounted only in dry locations, however as a precaution against stray moisture, the unit should be mounted with the wires pointing down
- (2) Metal in the building structure and in the building furnishings may reduce the sensitive of the receiver, and should be avoided in selecting the mounting location.
- (3) The receiver should be mounted at least 150cm (60 inches) above the floor, and 30cm and at least (30 inches) below the ceiling.
- (4) In use, the transmitter must be held at least 30cm (12 inches) from the receiver.
- (5) If this is a multi channel application, or other radio receivers are present a minimum of 20cm (8 inches) should be maintained between receivers.

3. Wiring of the Receiver:

The Receiver is compatible with all standard tubular motors. In connecting this unit, local building codes should be followed. Other items to be aware of are:

- (1) Make sure the power from the building supply has been disconnected when installing or servicing this unit.
- (2) The receiver contains static sensitive devices, and standard practices should be followed to discharge static charges from all components and the installer before touching the open unit or connecting components.
- (3) Use flexible wire and make sure there is no tension on wires connected to the terminal strip
- (4) Make sure that all ground (earth) wires are connected as shown.

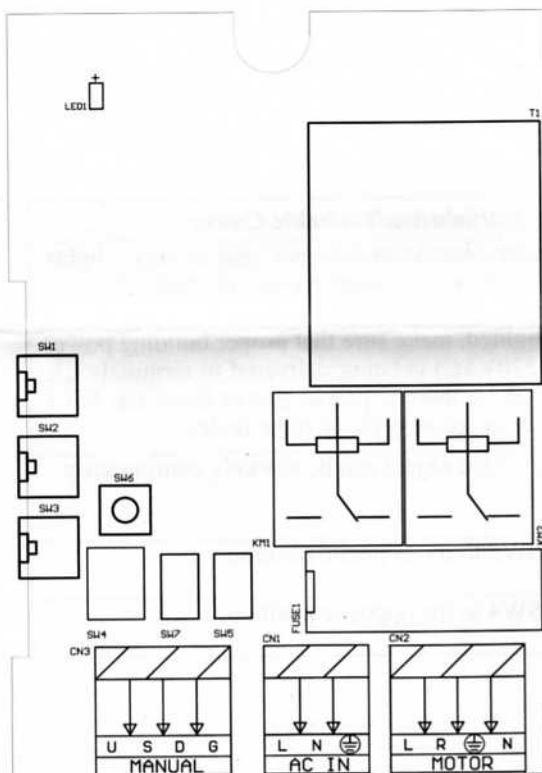

FUNCTION

- (1) FD1: Operation LED
- (2) SW5: Reversing Motor's direction
- (3) SW6: Program setting button
- (4) SW7: Reversing touch-action & continuous action
- (5) SW4: Reversing receiver Button's direct

WIRING

- (1) Motor Cable Terminals
 - 1.- L: UP/DOWN to Motor
 - 2.- R: DOWN/UP to Motor
 - 3.- Ⓧ: Earth (ground) to Motor
 - 4.- N: Common to motor
- (2) Main Power Terminals
 - 5.- L: Hot (ungrounded phase) of building supply
 - 6.- N: Neutral of building supply
 - 7.- Ⓧ: Earth (ground) of building supply
- (3) Dry-contact Switch Terminals
 - 8- U: UP/DOWN to Dry-contact switch
 - 9- S: Common to Dry-contact switch
 - 10- D: DOWN/UP to Dry-contact switch
 - 11- G: Common to Dry-contact switch

INSTALLATION GUIDE

Please read these instructions carefully before connecting the receiver.

4. Program setting

- (1) Press the setting button(SW6) until the FD2 light on the receiver begins flashing.(The receiver will return to the original state if no operation is done after 10 seconds.)
- (2) Press the round program setting button on the transmitter until the FD2 light of the receiver stops flashing. Programming is now complete.

Note: The receiver can only store 20channels.If you try to input the 21st channel, the command will be ignored and the LED light of the receiver will not flash.

5. Delete all stored channels' memory from the receiver

- (1) Press the program setting button(SW6) of the receiver for about 4 seconds until the FD2 light begins flashing and then quickly release the button.
- (2) Press this buttons(SW6) again within six seconds until the FD2 light stops flashing. All the memories in the receiver are deleted

6. Delete the stored memory of any channel

- (1) Press the setting button (SW6) of the receiver until the FD2 light begins flashing. Now the receiver is ready for a delete command from the transmitter
- (2) Press the **"DOWN"** button of the transmitter, the FD2 light of the receiver will stop flashing, indicating the memory has been deleted.

7. Replacing the transmitter's battery

- (1) Remove the screw from the back using a small Phillips screwdriver & then remove the back cover.
- (2) Take out the old battery and replace with a new one. (Type 27A 12VDC)
- (3) Replace the back cover and screw.
- (4) Please dispose of the old battery appropriately.

Troubleshooting

Symptom	Test/Solution/Probable Cause
The buttons on the receiver work properly, but nothing happens when the remote buttons are pressed.	If the LED on the transmitter does not light or only lights weakly when a button is pressed, replace the type 27A 12VDC battery in the transmitter.
Neither the transmitter or the receiver buttons work, and the receiver make no noise when these buttons are pressed.	If FD1 is not lighted, make sure that proper building power (115 VAC or 220VAC) is being delivered to terminals L& N of the receiver. If there is proper power there and FD 1 is not lighted the receiver is likely to be faulty.
Press the "DOWN" button of receiver or transmitter,the object will down too,but if release the button,the object will STOP	MOVE switch 7,the object can be working continuously.
The motor runs down when either the transmitter or receiver UP button is pressed.	Move switch SW5 to the opposite position.
The UP and DOWN work properly on the transmitter <u>or</u> the receiver, but they are reversed on the other.	Move switch SW4 to the opposite position.